

**I-BEAM DETAILS**

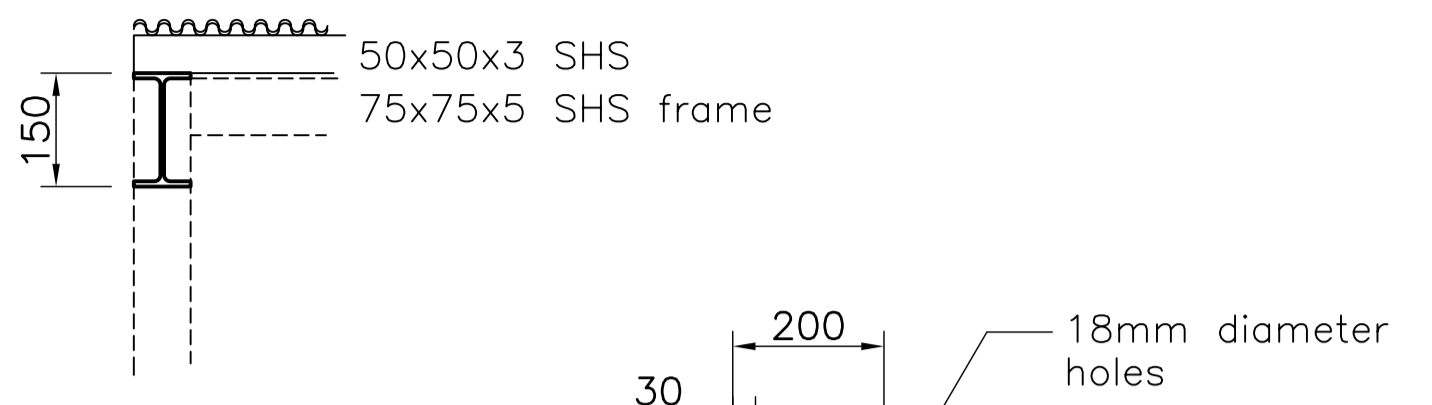

**BASE PLATE**

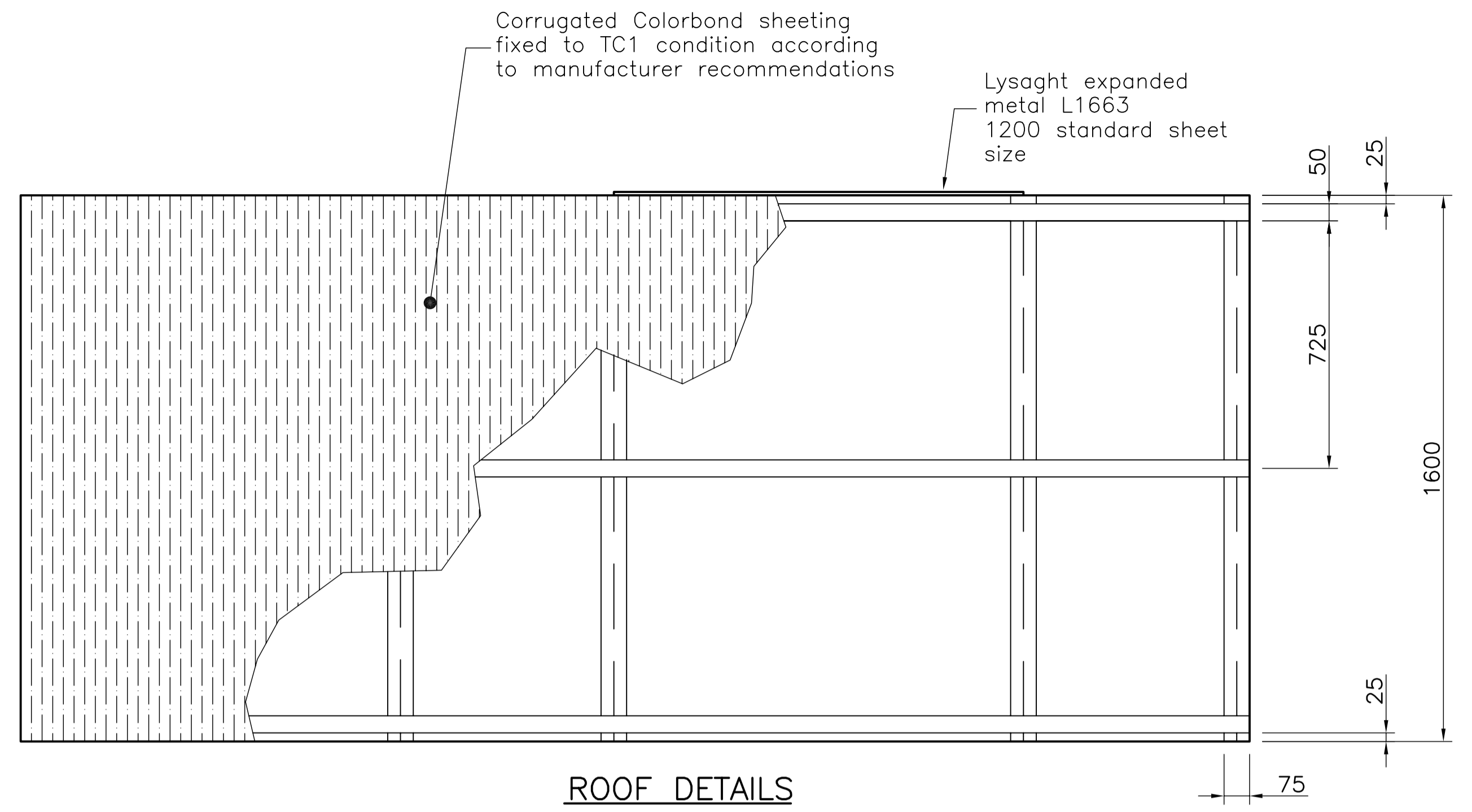

**ROOF DETAILS**

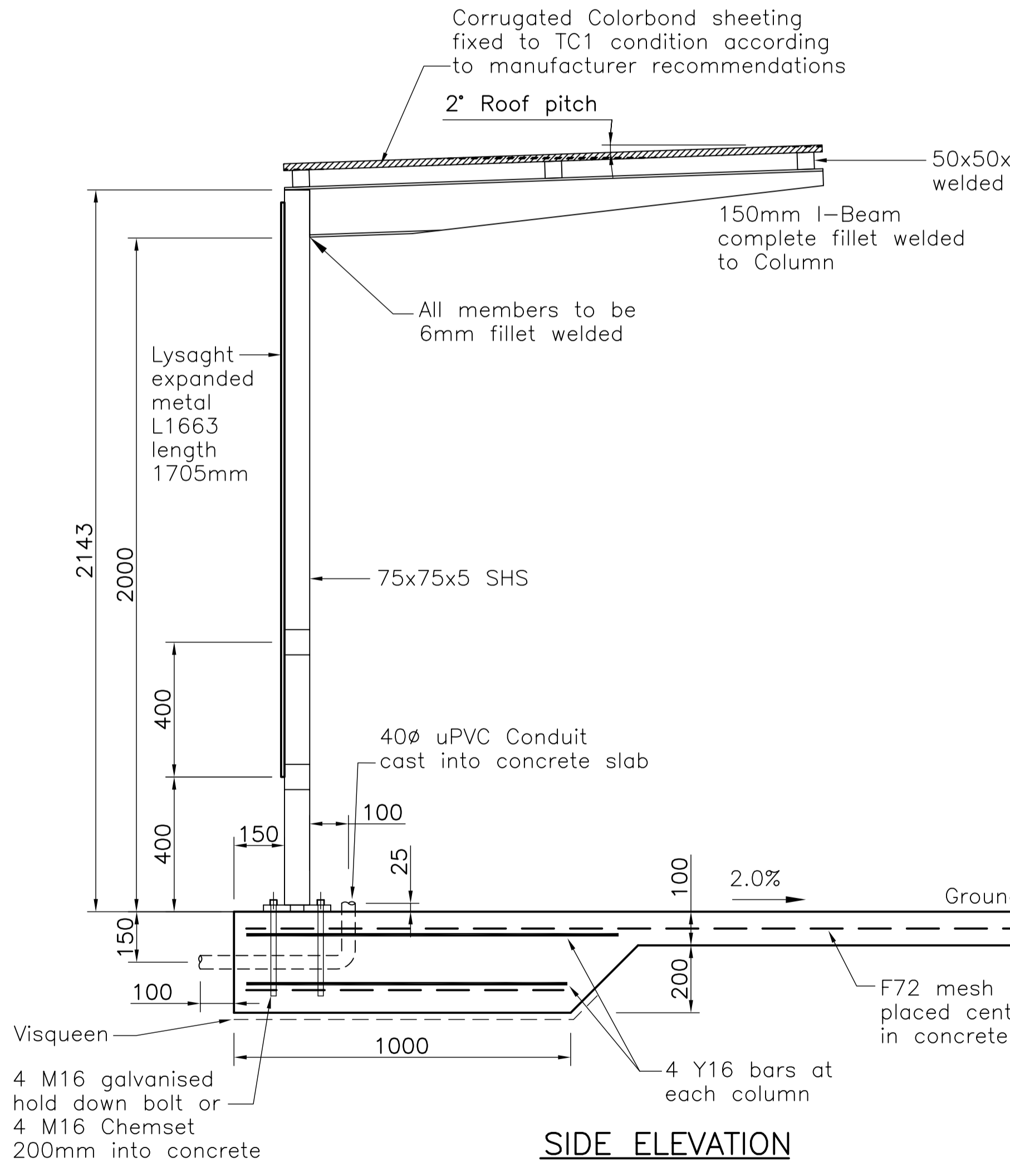

**SIDE ELEVATION**

**NOTES**

1. All dimensions are in millimetres unless noted otherwise.
2. Complete Frame and structural members to be hot dipped galvanised in accordance with AS4100.
3. Roof sheeting to be Corrugated Colorbond or similar.
4. All welds to be 6mm fillet welded.
5. N25 concrete (80mm slump +/- 15mm) to be in accordance with AS3600 Concrete Code.
6. Seat to be installed separately, to stand alone.

**PUBLIC ART ALTERNATIVE**

Shelter frame to be powder coated (colour to suit). Back panel to become Public Art Image panel.

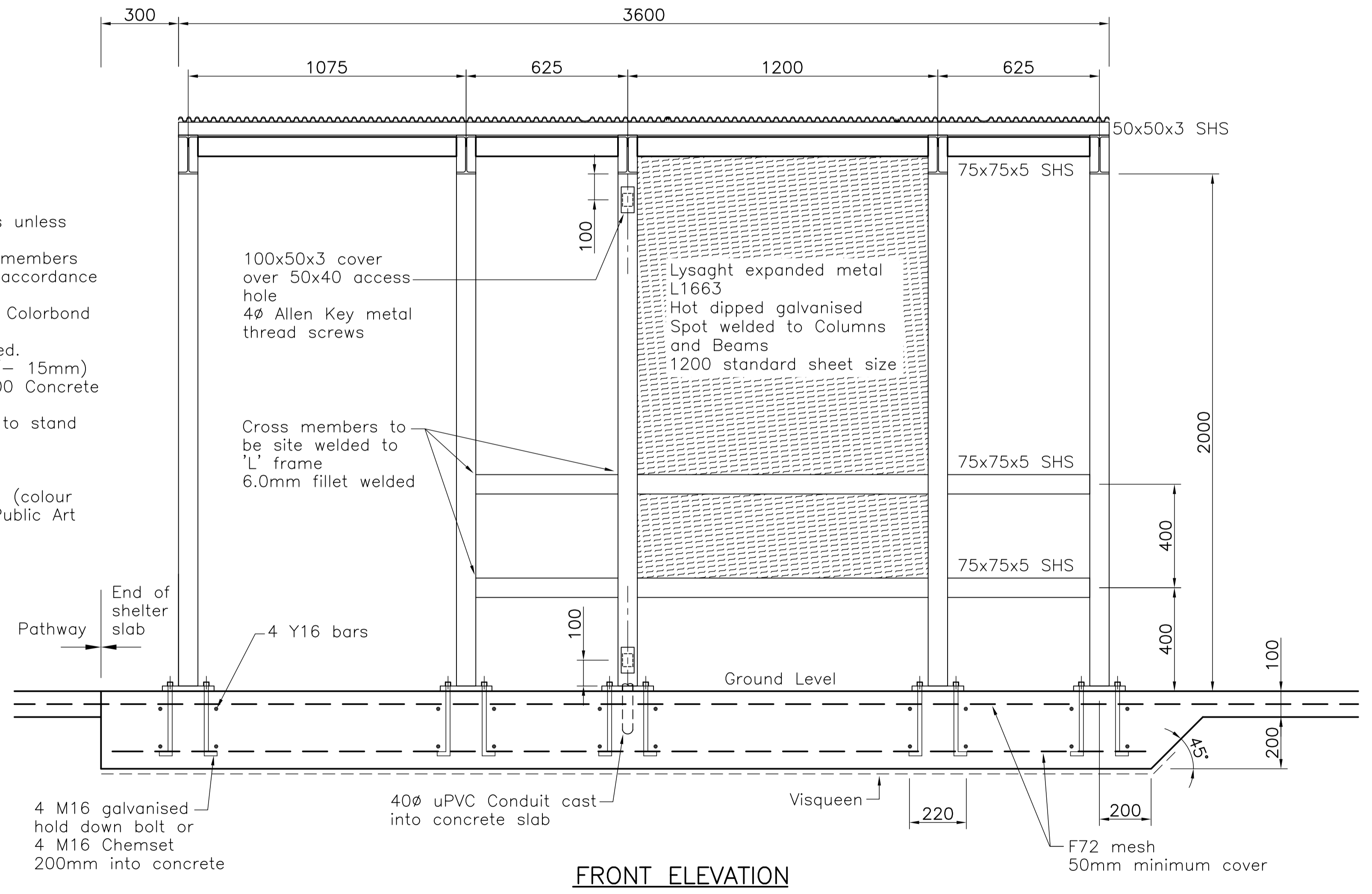

**FRONT ELEVATION**

No.	DATE	DESCRIPTION	AP'D
D	13/2/2008	NOTES AMENDED IN ACCORDANCE WITH AUSTRALIAN STANDARDS	
C	2/8/2007	ROOF WELDING CHANGES TO CROSS MEMBERS AND CONDUIT LOCATION	
B	3/5/2007	1250 DIMENSION POSTS CHANGED TO 1200, STANDARD LYSAGHT SHEET SIZE	
A	4/4/2007	ORIGINAL ISSUE	
		REVISIONS	

NOTES :  
Not to Scale

**THE CITY OF THURINGOWA**

86 Thuringowa Drive  
Thuringowa Central, QLD, 4817  
Phone : (07) 4773 8411  
Fax : (07) 4773 8571  
Email : council@thuringowa.qld.gov.au  
Web : www.thuringowa.qld.gov.au

DRAWN: NRM	Engineer Approved: Original signed by B.Sue Date: 18/2/2008
CHECKED: WJP	Director Approved: Original signed by C.Phillips Date: 19/2/2008

**BACK PANEL STYLE BUS SHELTER  
DISABILITY COMPLIANT DESIGN**

**STANDARD  
DRAWING  
ROADWORKS**

**10122**

A	B	C	D
---	---	---	---