

SAWCUT JOINT

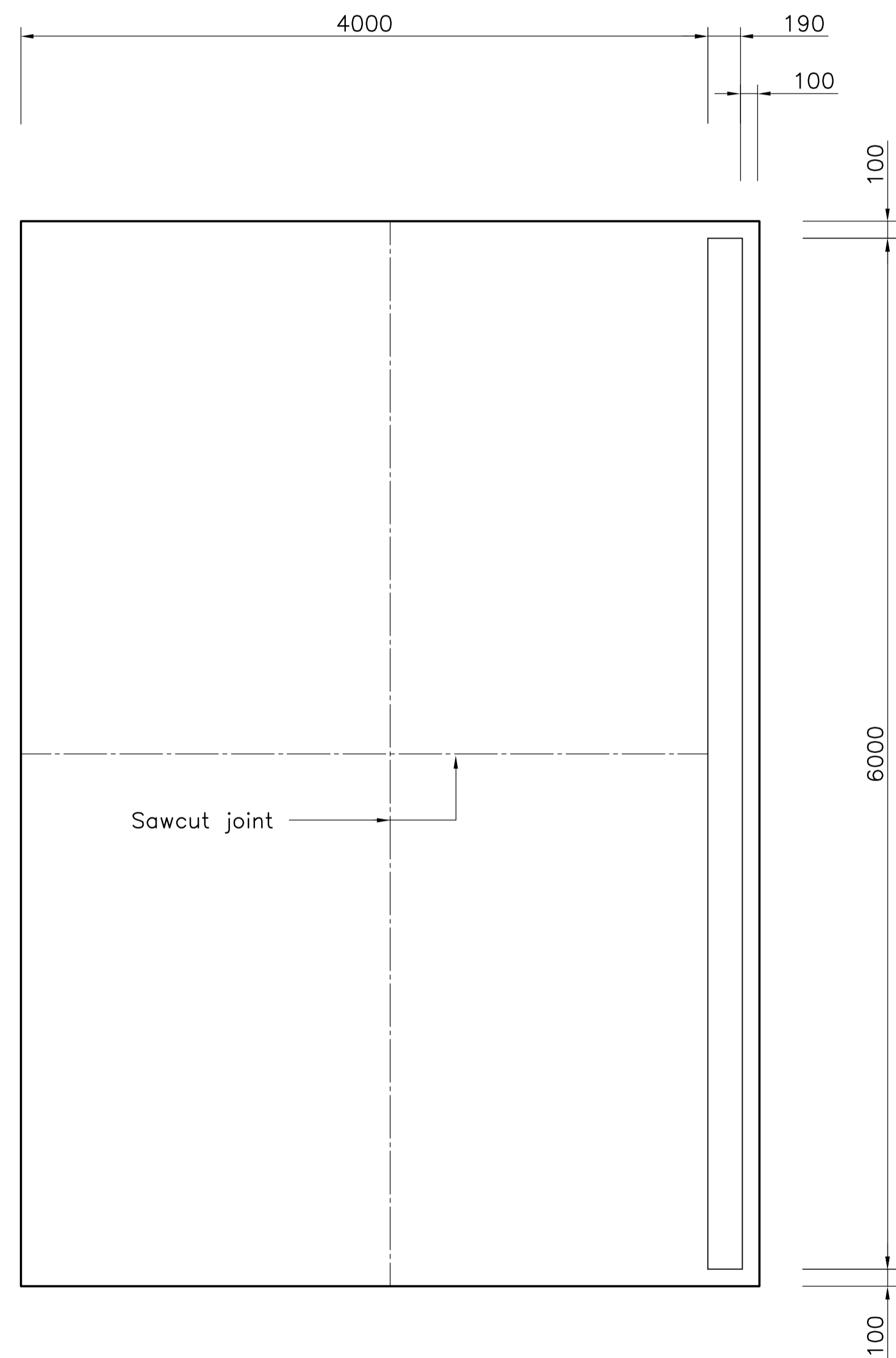

PLAN

GENERAL NOTES

1. All dimensions are in millimetres unless noted otherwise.

CONCRETE WORK NOTES

- Concrete Proportioning and Testing to be in accordance with the current edition of AS3600 – Concrete Structures and AS3735 – Concrete for retaining Liquids.
- Strength Grade =
Ground Floor Slabs Thickenings – 25MPa
Retaining Walls including Footing – 32MPa
- Concrete cover to reinforcement including Ties and Hoops shall be not less than the following unless shown otherwise:

| Element | In Interior Environments | In Exterior Environments | In Contact with Ground | |
|----------------|--------------------------|--------------------------|------------------------|-----------------------|
| | | | Placed in Formwork | Placed Against Ground |
| Slab on Ground | – | 40 | 40 | 50 |
| Pad Footings | – | 40 | 40 | 50 |
| Retaining Wall | – | 30 | 30 | – |

Forms to comply with AS1509.

Cover is to be maintained during pouring of concrete by the use of plastic chairs at maximum 750 CTS in each direction. For work in contact with the ground, chairs are to be supported on sheet plates. Concrete cast on or against the ground shall be protected by a Damp Proof Membrane.

- Reinforcement is to be in accordance with the latest SAA specifications. Material is indicated by the following symbols:
R Plain Bars – Grade 250
Y Structural Grade Deformed – Grade 400
F Fabric – Grade 450
W Steel Wire – Grade 450
The bar size is indicated by a number after the above symbol. This number is the number of millimetres in the bar diameter. Reinforcement is represented diagrammatically and is not necessarily shown in true projection.
- Lap bars 40 diameters at splices unless noted otherwise.
- Fabric is to comply with Australian Standard Code requirements and to have minimum lap splice as follows:
Square Mesh – Wire spacing x2 times for wires in each direction
- Welding reinforcement will not be permitted unless shown on the structural drawings.
- Construction Joints shall be established strictly as shown on the drawings.

- Formwork shall be designed and constructed in accordance with AS3610.
- Sizes of concrete elements do not include thickness of applied finishes.
- No holes, chases or embedment of pipes other than those shown on the structural drawings shall be made in concrete members without the approval of the Engineer.
- Splices in reinforcement shall be made only in the positions shown or as otherwise approved by the Engineer. Where the lap lengths are not shown, laps shall be a minimum of 37.5 bar diameters. Fabric shall be lapped such that the two outermost wires of one sheet overlap the two outermost wires of the other sheet.
- All form edges and re-entrant corners shall be chamfered or filleted 20mm.
- Compaction of concrete during placing shall be by mechanical vibrators. Concrete shall be placed by pump or kibble.
- Curing of all concrete surfaces is to be carried out immediately after finishing as per AS3600 Section 4.

MASONRY NOTES

- Masonry and Masonry work shall conform to AS3700 – SAA Masonry Code.
- Characteristic Compressive Strength Units shall be as follows:
Concrete Masonry Units – 15MPa
- Mortar classification shall be M4 in accordance with AS3700.
- Horizontal bed joint reinforcement shall be provided at 400 CTS where noted.
- All reinforced cores where shown or noted shall be concrete core filled, Strength grade N20 MPa.
- Maximum slump core fill concrete – 225mm.
- Minimum grout cover to reinforcement shall be 20mm unless noted otherwise.
- Masonry cores shall be concrete filled where masonry anchors are required.
- Control Joints in concrete masonry walls shall be at not greater than 12m CTS.
- Wall Ties shall be heavy duty galvanised steel in accordance with AS2699, spacing shall be as follows:
Generally – 600 CTS horizontally and vertically
Adjacent openings – 400 vertically.

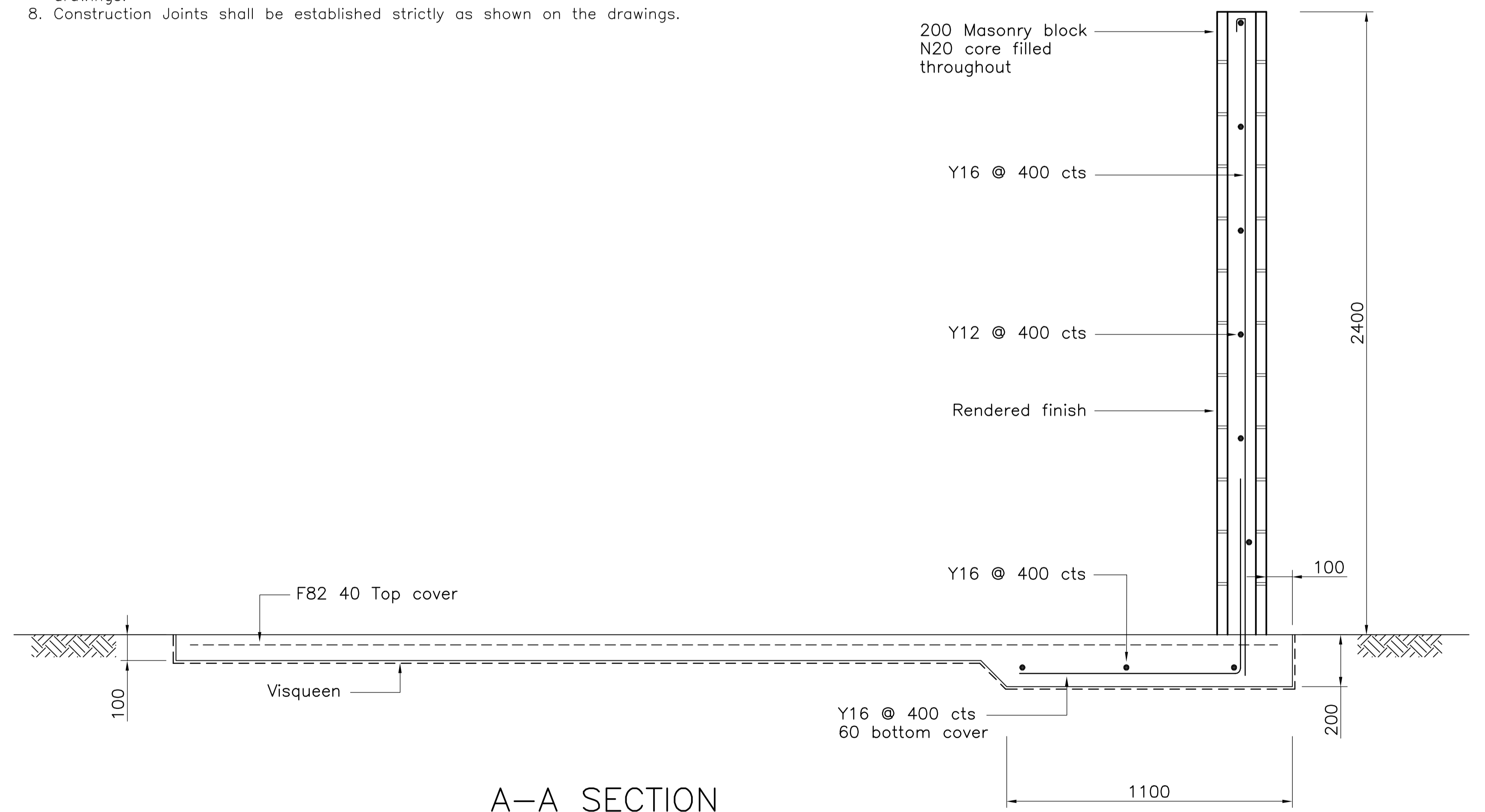

A-A SECTION

| No. | DATE | DESCRIPTION | AP'D |
|-----------|------------|----------------|------|
| A | 26/10/2004 | ORIGINAL ISSUE | |
| REVISIONS | | | |

NOTES :
Not to Scale

THE CITY of THURINGOWA

86 Thuringowa Drive
Thuringowa Central, QLD, 4817
Phone : (07) 4773 8411
Fax : (07) 4773 8571
Email : council@thuringowa.qld.gov.au
Web : www.thuringowa.qld.gov.au

DRAWN: NRM
Engineer Approved: Original Signed By B.Sue Date: 9/11/04

CHECKED: WJP
Director Approved: Original Signed By B.Bailey Date: 9/11/04

REBOUND WALL

STANDARD DRAWING MISCELLANEOUS

10620

A