

SECTION A

Aproximate:
 Weight of Box - 33.1kg
 Weight of Cover - 13.6kg
 Material - Cast Iron
 Bitumen Coated

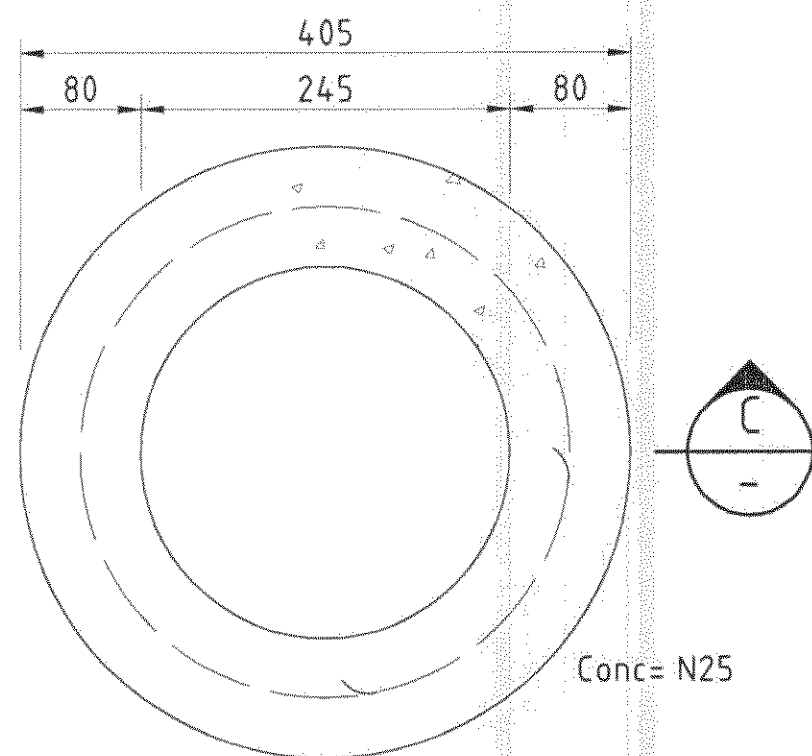

Conc = N25

CONCRETE RINGS

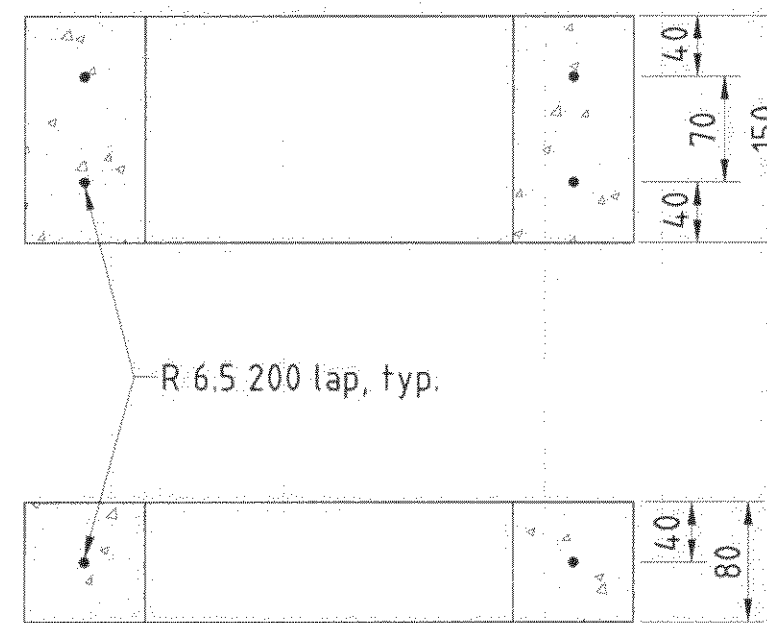

SECTIONS C

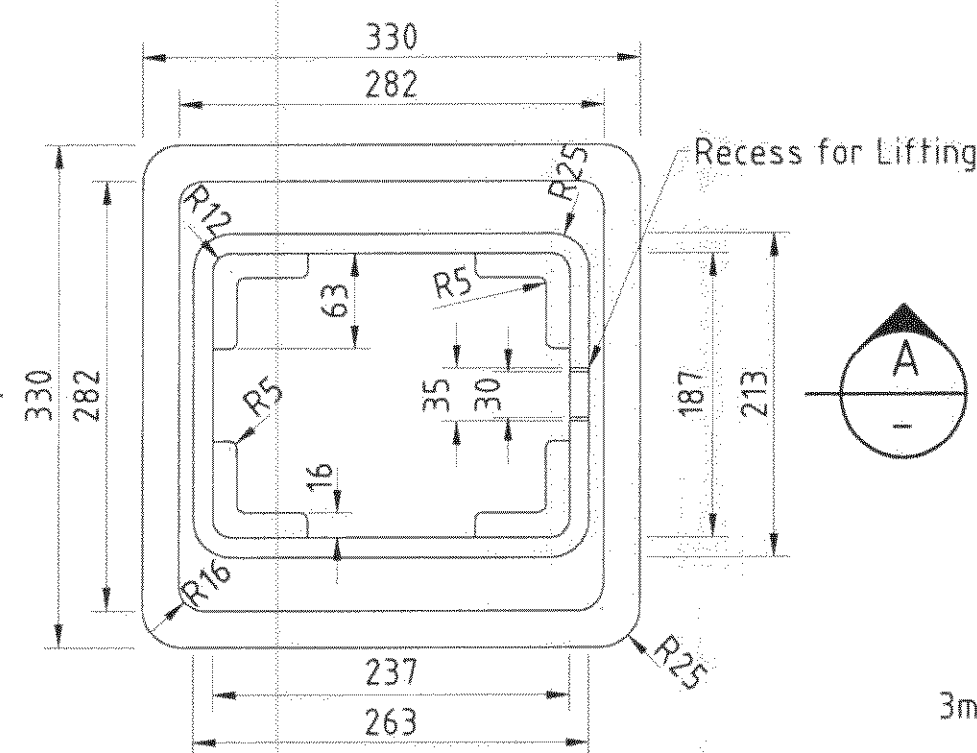

PLAN OF BOX

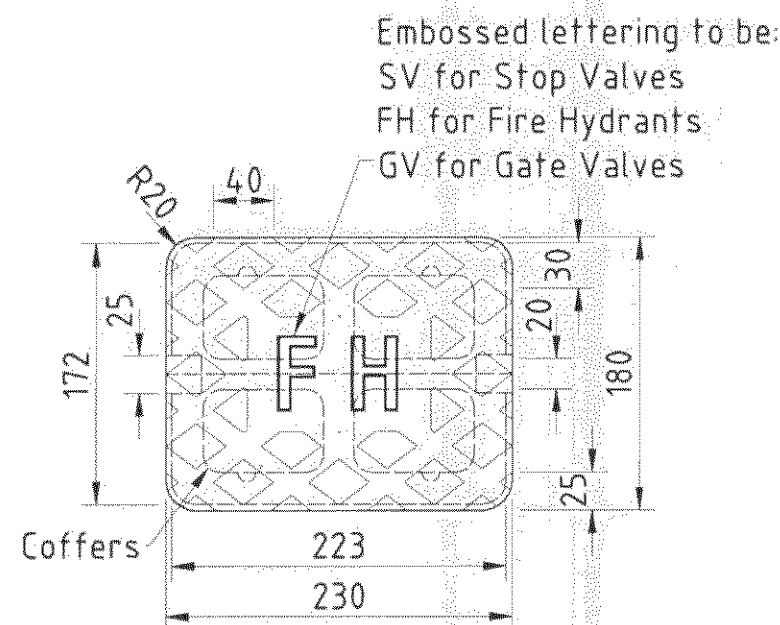

PLAN OF COVER

Embossed lettering to be:
 SV for Stop Valves
 FH for Fire Hydrants
 GV for Gate Valves

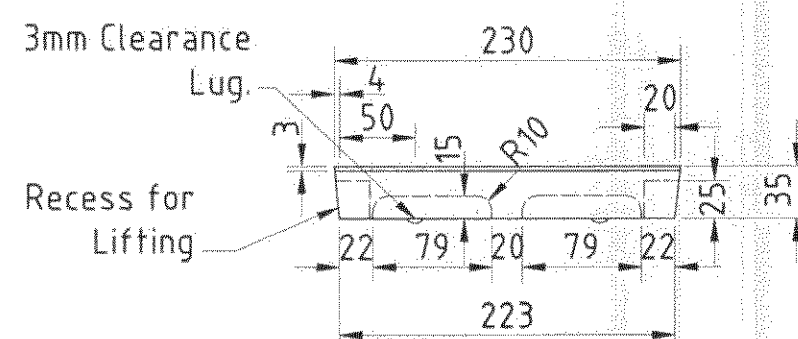

ELEVATION

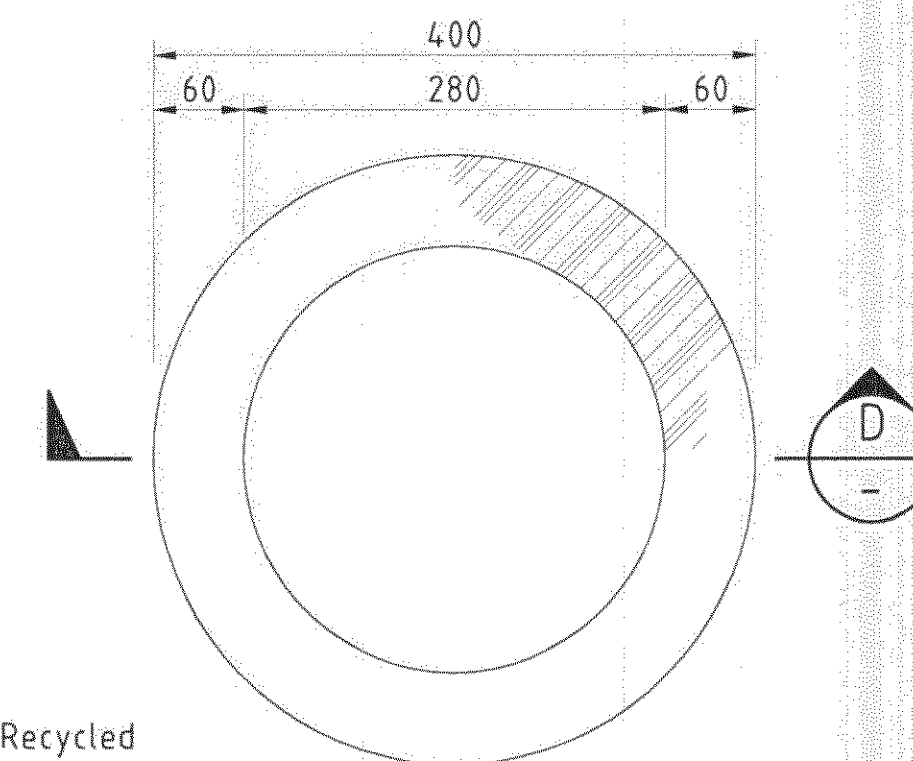

SECTION D
 RECYCLED PLASTIC RING

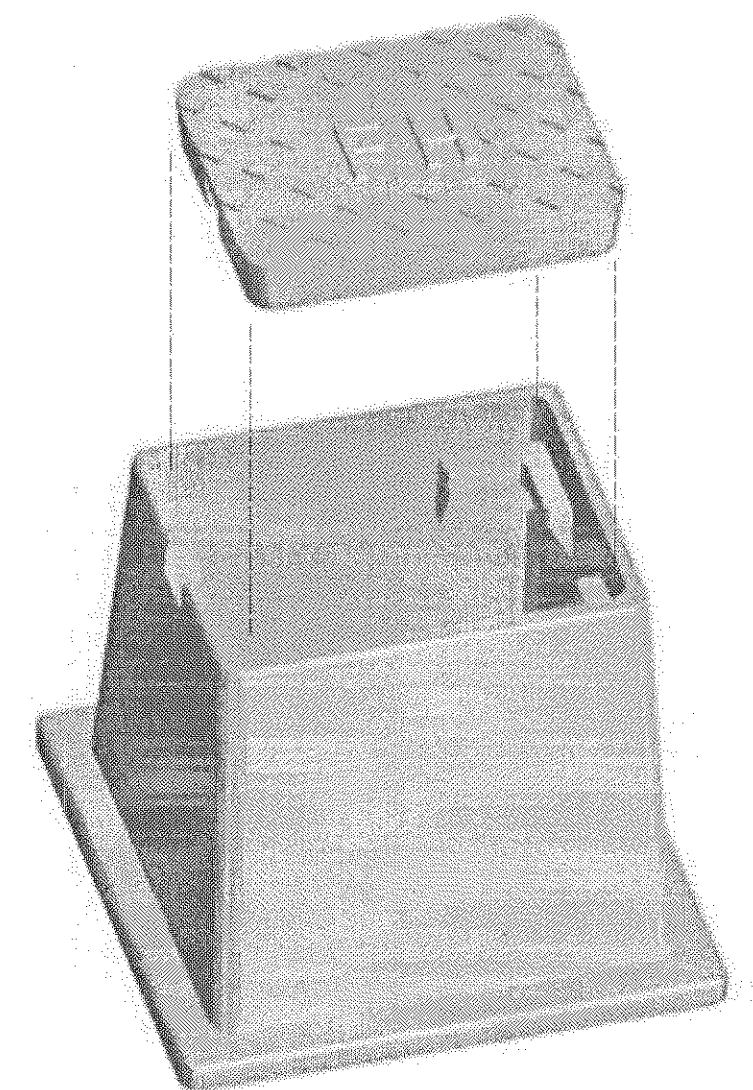

3D MODEL
 NTS

Note:
 Typical box shown, other types
 may be used with written approval
 from Citewater.

**STOP VALVE AND
 FIRE HYDRANT BOX AND COVER**

Scale 1:5

ZONE	REF.	REVISIONS	BY	CKD.	DATE
	C	REDRAWN CAD, UPDATED	OFC	M	17.06.03
	B	SLUICE VALVE BOX DELETED	-	-	09.11.92
	A	RETRACE	-	-	27.12.79
	-	ORIGINAL	-	-	-

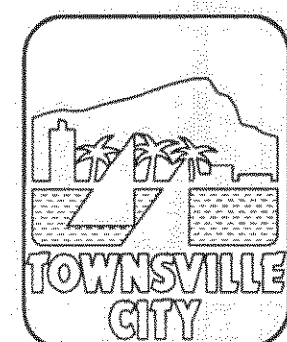

ASSOCIATED DRAWINGS	
LEVEL	DATUM
A.H.D.	CC 031
ERGON	TELSTRA

CITIWATER
 TOWNSVILLE

APPROVED
[Signature] 24/6
 RPEQ 4693
 MANAGER

[Signature] 20/03/03
 RPEQ 6010
 TECHNICAL SERVICES ENGINEER

DES.	
DRN.	
SD.	17/06/03
S/ENG	

WATER SUPPLY-STANDARDS COVERS AND BOXES FOR STOP VALVES, STOP COCKS, FIRE HYDRANTS & CONCRETE RINGS				
DATE	M/FILM	SCALE	DRAWING NO.	
17.06.03		as shown	13421 C	A2