

Appendix U

**SARA Decision notice – Haughton
Pipeline Stage 2 2201-26844 SDA**



SARA reference: 2201-26844 SDA
 Applicant reference: 12537606

14 June 2022

Townsville City Council
 C/- GHD Pty Ltd
 71 Stanley Street
 TOWNSVILLE QLD 4810
Erin.Campbell@ghd.com

Attention: Erin Campbell

Dear Ms Campbell

SARA Decision notice— Haughton Pipeline Stage 2

(Assessment Manager decision notice given under section 63 of the *Planning Act 2016*)

The development application described below was confirmed as properly made by the State Assessment and Referral Agency (SARA) on 10 February 2022.

Decision

Outcome:	Approved, subject to conditions
Date of decision:	14 June 2022
Conditions:	The approval is subject to the conditions in Attachment 1 .
Advice:	Advice to the applicant is in Attachment 2 .
Reasons:	The reasons for decisions are in Attachment 3 .
Currency period:	This development approval will lapse if development is not started within the currency periods stated in section 85 of the <i>Planning Act 2016</i> .

Development Details

Description:	Development permit	Operational work for an underground water supply pipeline and associated ancillary works for construction consisting of temporary access, haulage roads and stockpile areas
SARA role:	Assessment manager	
SARA trigger:	Schedule 10, Part 9, Division 4, Subdivision 2, Table 5, Item 1 (Planning Regulation 2017) – Development application impacting State	

	transport corridors
	Schedule 8, Table 4, Item 3 b (Planning Regulation 2017) – Development application involving the clearing of native vegetation
SARA reference:	2201-26844 SDA
Street address:	Stockham Road, Upper Haughton; Ravenswood Road, Mulgrave; Woodhouse Road, Mulgrave; 695 Woodhouse Road, Mulgrave; 507 Woodhouse Road, Mulgrave; 749 Woodhouse Road, Mulgrave; 693 Woodhouse Road, Mulgrave; 829 Keith Venables Road, Upper Haughton; Stockham Road, Upper Haughton; Millett Road, Upper Haughton; Woodhouse Road, Mulgrave; 4375 Ayr Dalbeg Road, Mulgrave; 831 Keith Venables Road, Upper Haughton; Keith Venables Road, Upper Haughton; Keith Venables Road, Upper Haughton; 132 Ravenswood Road, Mulgrave; 1029 Woodhouse Road, Mulgrave
Real property description:	101SP111327; 15CP891307; 170GS804007; 1AP23197; 22GS1042; 259 GS804008; 2AP23197; 2SP302825; 301SP107466; 302SP107469; 308GS1041; 33SP117630; 3SP302825; 4SP107479; 5SP107479; 71SP289517; 261GS804009
Local government area:	Burdekin Shire Council
Applicant name:	Townsville City Council C/- GHD Pty Ltd
Applicant contact details:	71 Stanley Street Townsville QLD 4810 Erin.Campbell@ghd.com

Additional details

Native title considerations:	No requirements
Level of assessment:	Code assessable

Dispute resolution

Representations:	The rights of applicants to make representations about this decision notice during the applicant's appeal period is set out in Chapter 3, Part 5 of the <i>Planning Act 2016</i> . Copies of the relevant provisions are in Attachment 4 .
Appeal:	The rights of applicants to appeal to a tribunal or the Planning and Environment Court against decisions about a development application are set out in Chapter 6, Part 1 of the Planning Act. Copies of the relevant appeal provisions are in Attachment 5 .

For further information please contact Soraya Torrens, Senior Planner, on 0734527695 or via email DAAT@dSDLGP.qld.gov.au who will be pleased to assist.

Yours sincerely

A handwritten signature in black ink, appearing to read 'C. Aston', written over a light grey rectangular background.

Christopher Aston
State Planner

enc **Attachment 1** – Assessment manager conditions
 Attachment 2 – Advice to the applicant
 Attachment 3 – Reasons for the decision
 Attachment 4 – Change representation provisions
 Attachment 5 – Appeal provisions
 Attachment 6 – Approved plans and specifications

cc Burdekin Shire Council, planning@burdekin.qld.gov.au

Attachment 1—Assessment manager conditions

(Given under section 63(2)(e)(ii) of the *Planning Act 2016*)

(Copies of the plans and specifications referenced below are found at **Attachment 6**)

No.	Conditions of development approval	Condition timing
Operational work		
The chief executive administering the <i>Planning Act 2016</i> nominates the Director-General of Department of Transport and Main Roads to be the enforcement authority for the development to which this development approval relates for the administration and enforcement of any matter relating to the following condition(s):		
1.	Pay a monetary contribution of \$61,312 to the Department of Transport and Main Roads North.Queensland.IDAS@tmr.qld.gov.au towards protecting or maintaining the safety or efficiency of the Ayr-Ravenswood Road and Ayr-Dalbeg Road.	Prior to the commencement of works
2.	<p>(a) Prepare a Traffic Management Plan (TMP) by a Registered Professional Engineer of Queensland. The TMP must demonstrate that there will be no disruption to the safety and operational integrity of state-controlled road and railway level crossings during the course of construction.</p> <p>(b) Submit the TMP to the Department of Transport & Main Roads North.Queensland.IDAS@tmr.qld.gov.au.</p> <p>(c) Undertake the works in accordance with the TMP.</p>	<p>(a) & (b) Prior to the commencement of works</p> <p>(c) At all times during the construction of the development</p>
The chief executive administering the <i>Planning Act 2016</i> nominates the Director-General of Department of Resources to be the enforcement authority for the development to which this development approval relates for the administration and enforcement of any matter relating to the following condition(s):		
3.	<p>Clearing of vegetation must:</p> <p>(a) only occur within Area A (Parts A1 – A13) as shown on the attached:</p> <ol style="list-style-type: none"> i. Vegetation Management Plan, prepared by Queensland Government, reference VMP 2201-26844 SDA, Sheets 1 - 7, version 2 ii. Attachment to Vegetation Management Plan (VMP 2201-26844 SDA) Derived Reference Points for GPS. <p>(b) not exceed 127.81 ha.</p>	At all times
4.	Any person(s) engaged or employed to carry out the clearing of vegetation under this development approval must be provided with a full copy of this development approval and must be made aware of the full extent of clearing authorised by this development approval.	Prior to clearing commencing
5.	Clearing must be undertaken, and the impacts of clearing must be managed, in accordance with the submitted Conceptual Sediment and Erosion Control Plan, prepared by GHD Pty Ltd dated 17/12/2021.	As per the sediment and erosion control plan

Attachment 2—Advice to the applicant

General advice	
1.	Terms and phrases used in this document are defined in the <i>Planning Act 2016</i> its regulation or the State Development Assessment Provisions (SDAP) v2.6. If a word remains undefined it has its ordinary meaning.
State transport	
2.	<p>Under the Transport Infrastructure (Rail) Regulation 2006 permission from the Railway Manager (Queensland Rail) is required to take over-dimensional road loads across Queensland Rail infrastructure (e.g. rail level crossings and rail bridges).</p> <p>Further information can be obtained from Queensland Rail's website at: http://www.queenslandrail.com.au/forbusiness/overdimensionalloads</p>
3.	<p>Under sections 33 of the <i>Transport Infrastructure Act 1994</i>, written approval is required from the Department of Transport and Main Roads (DTMR) to carry out road works that are road access works (including driveways) on a state-controlled road. Please contact the DTMR via North.Queensland.Idas@tmr.qld.gov.au to make an application for road works approval.</p> <p>The approval process may require the approval of engineering designs of the proposed works, certified by a Registered Professional Engineer of Queensland (RPEQ). Please contact the Department of Transport and Main Roads as soon as possible to ensure that gaining approval does not delay construction.</p>
4.	<p>An application for a Road Corridor Permit is required for any ancillary works and encroachments on the state-controlled road under section 50(2) and Schedule 6 of the <i>Transport Infrastructure Act 1994</i>. Please contact DTMR via email TOWDAWE@tmr.qld.gov.au to make an application for a Road Corridor Permit.</p> <p>It is recommended that applications are submitted at least 4 weeks before the date the permit is required. Additional time may be required to assess the impacts and requirements for some larger structures.</p>
5.	<p>Written agreement and approval from the Chief Executive of DTMR under Chapter 6, Division 3, Public utility plant on State-controlled roads must be obtained prior to the installation of the proposed pipeline. An application for written agreement and approval must be submitted by the asset owner and can be made by completing the F5165 - Installation of Utility Assets in State-Controlled Roads Application and F5191 Deed of Indemnity and submitting them to DTMR (Utilities (Department of Transport and Main Roads) (tmr.qld.gov.au)).</p> <p>Section 79 of the <i>Transport Infrastructure Act 1994</i> enables (inter-alia) the Chief Executive of the DTMR to impose requirements and conditions upon the owner of public utility plant on a State-controlled road. These conditions are detailed section 11 of the Transport Infrastructure (State-controlled roads) Regulation 2017.</p> <p>All utilities that wish to access and install assets in the state-controlled road network must comply with the technical requirements specified in the TN163 Third Party Utility Infrastructure Installation in State Controlled Roads Technical Guidelines (Technical notes (Department of Transport and Main Roads) (tmr.qld.gov.au))</p>
Native Vegetation Clearing	
6.	Other permits or approvals may be required for the clearing of vegetation. To determine if the

	proposed clearing requires other approvals under other local, State or federal laws go to www.qld.gov.au (search 'vegetation clearing requirements').
7.	To request an electronic file of the Derived Points (Attached to Plan: VMP 2201-26844 SDA) as contained in this technical agency response, email a request to the Department of Resources at vegetation.support@resources.qld.gov.au and include application reference (2201-26844 SDA).

Attachment 3—Reasons for the decision

(Given under section 63(5) of the *Planning Act 2016*)

The reasons for SARA's decision are:

The development complies with State code 1: Development in a State controlled road environment and State code 6: Protection of State transport networks of the State Development Assessment Provisions (SDAP). Specifically, the development:

- does not create a safety hazard for users of a state-controlled road, by increasing the likelihood or frequency of fatality or serious injury
- does not result in a worsening of the physical condition or operating performance of state-controlled roads and the surrounding road network
- does not compromise the state's ability to maintain and operate state-controlled roads, or significantly increase the cost to maintain and operate state-controlled roads.

The development complies with State code 16: *Native vegetation clearing* of the SDAP. Specifically, the development:

- minimises clearing to conserve vegetation, avoid land degradation and loss of biodiversity and maintains ecological processes
- avoids impacts on vegetation that are matters of state environmental significance and where it can't be avoided, the development minimises and mitigates impacts.

Material used in the assessment of the application:

- The development application material and submitted plans
- *Planning Act 2016*
- Planning Regulation 2017
- The *State Development Assessment Provisions* (version 2.6), as published by SARA
- Technical Agency advice
- The Development Assessment Rules
- SARA DA Mapping system

Attachment 4— Change representation provisions

Attachment 5—Appeal provisions

Attachment 6—Approved plans and specifications

(given under section 43 (b) of the Planning Regulation 2017)



PLANS AND DOCUMENTS
referred to in the
DEVELOPMENT APPROVAL



SARA ref: 2201-26844 SDA

Date: 13 June 2022

Haughton Pipeline Stage 2 Project

Conceptual Erosion and Sediment Control Plan

Townsville City Council

17 December 2021

→ The Power of Commitment



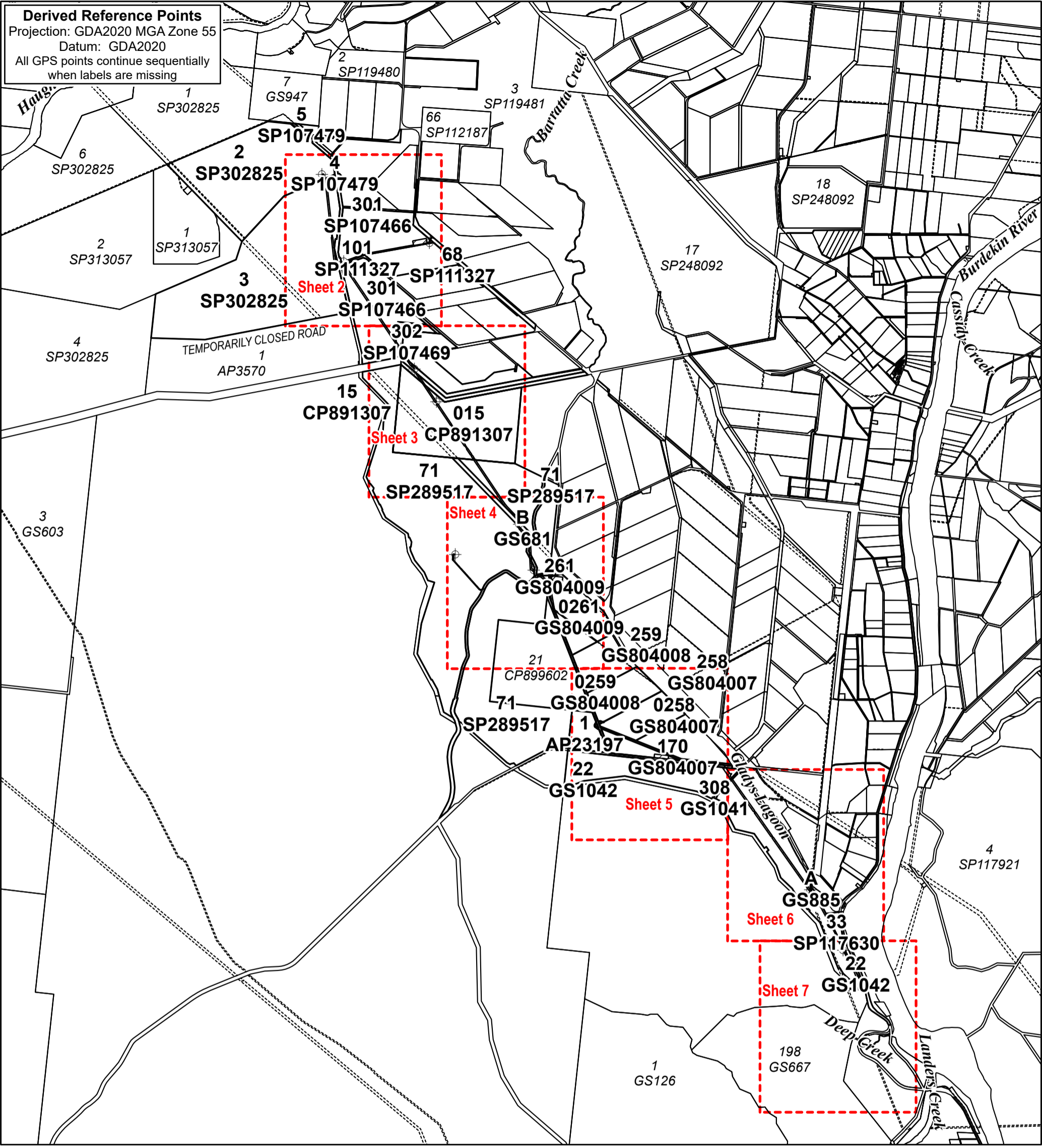

Derived Reference Points
 Projection: GDA2020 MGA Zone 55
 Datum: GDA2020
 All GPS points continue sequentially when labels are missing

1:100000 @ A3 size

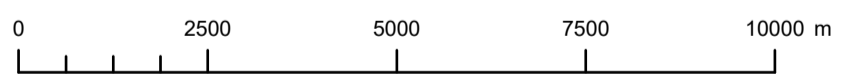

Projection: UTM (MGA Zone 55) Datum: GDA2020

Notes: Derived Reference Points are provided to assist in the location of area boundaries. Responsibility for locating these boundaries lies solely with the landholder.
 Watercourse and drainage feature locations shown on the Vegetation Management Plan are derived from the certified Vegetation Management Watercourse and Drainage Feature Map. These alignments are approximate only and require ground truthing to identify the exact location of the watercourse or drainage feature.
 The property boundaries shown on this plan are APPROXIMATE ONLY. They are NOT an accurate representation of the legal boundaries.

This plan must be read in conjunction with conditions attached to 2201-26844 SDA

LEGEND

- Derived Reference Start Points (see attachment)
- Subject Lot(s)
- Area A - Clearing permitted

PLANS AND DOCUMENTS referred to in the DEVELOPMENT APPROVAL

SARA ref: 2201-26844 SDA

Date: 13 June 2022

Note: This is a colour plan and should only be reproduced in colour

Vegetation Management Plan

Plan of Area A (Parts A¹ - A¹³) in Lot 308 on Plan GS1041, Lot 22 on Plan GS1042, Lot A on Plan GS885, Lot 33 on Plan SP117630, Lot 015 on Plan CP891307, Lot 0261 on Plan GS804009, Lot 0259 on Plan GS804008, Lot 0258 on Plan GS804007, Lot 1 on Plan AP23197, Lot 2 on Plan AP23197, Lot 261 on Plan GS804009, Lot 259 on Plan GS804008, Lot 258 on Plan GS804007, Lot 170 on Plan GS804007, Lot 15 on Plan CP891307, Lot E on Plan GS804009, Lot 68 on Plan SP111327, Lot 101 on Plan SP111327, Lot 3 on Plan SP302825, Lot X on Plan SP302825, Lot 302 on Plan SP107469, Lot 301 on Plan SP107466, Lot C on Plan GS431, Lot 5 on Plan SP107479, Lot 4 on Plan SP107479, Lot 2 on Plan SP302825, Lot 71 on Plan SP289517, Lot B on Plan GS681 and roads

Version: 2 eLVAS Case ID: 2022/000569

© The State of Queensland, 2022

VMP

2201-26844 SDA

Sheet 1 of 7

Derived Reference Points
 Projection: GDA2020 MGA Zone 55
 Datum: GDA2020
 All GPS points continue sequentially
 when labels are missing

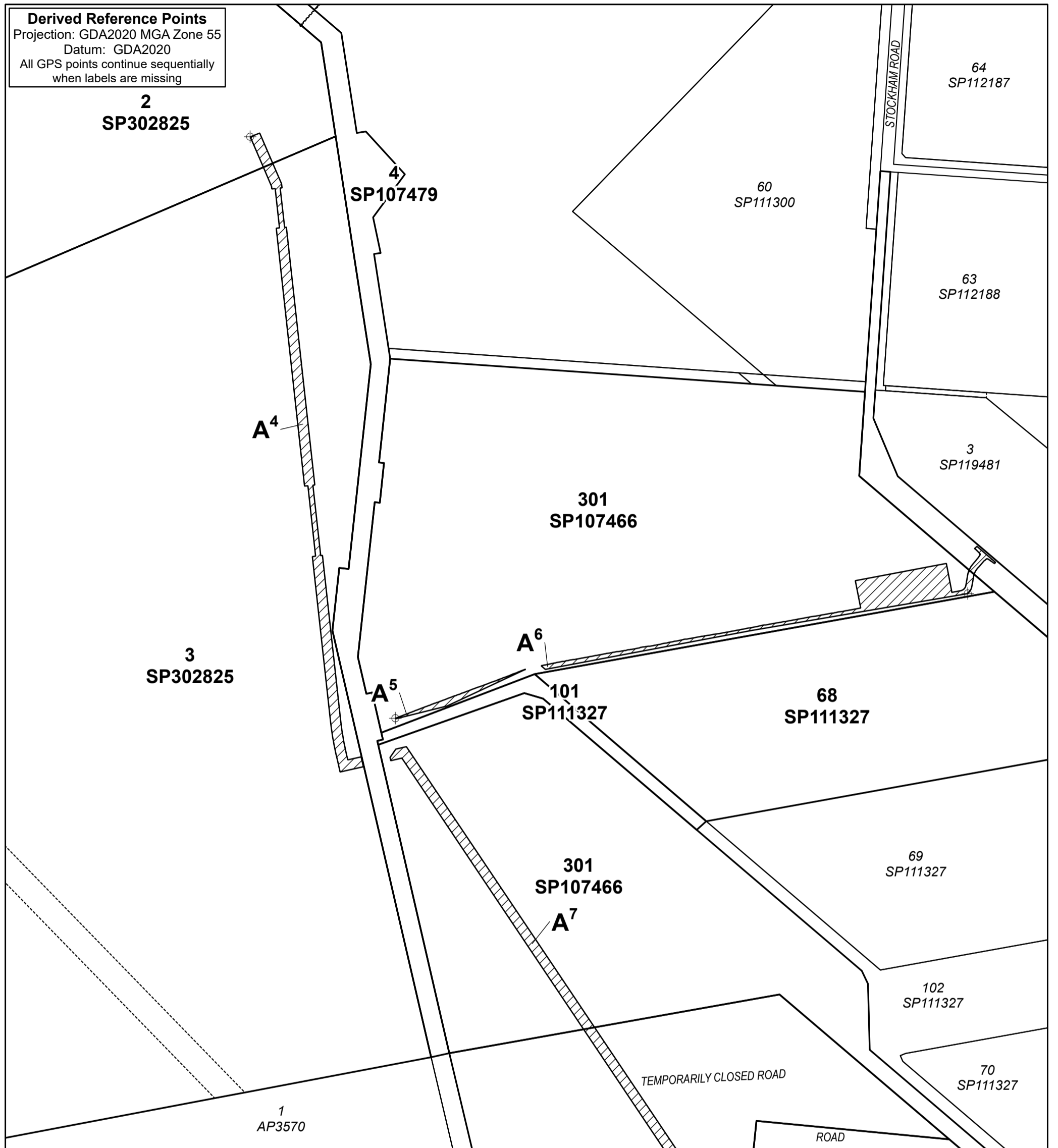

1:15000 @ A3 size

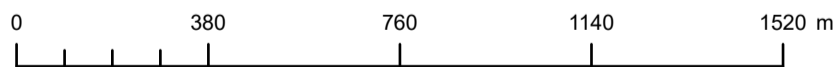

Projection: UTM (MGA Zone 55)

Datum: GDA2020

Notes: Derived Reference Points are provided to assist in the location of area boundaries. Responsibility for locating these boundaries lies solely with the landholder.

Watercourse and drainage feature locations shown on the Vegetation Management Plan are derived from the certified Vegetation Management Watercourse and Drainage Feature Map. These alignments are approximate only and require ground truthing to identify the exact location of the watercourse or drainage feature.

The property boundaries shown on this plan are APPROXIMATE ONLY. They are NOT an accurate representation of the legal boundaries.

This plan must be read in conjunction with conditions attached to 2201-26844 SDA

LEGEND

Derived Reference Start Points (see attachment)

Subject Lot(s)

Area A - Clearing permitted

**PLANS AND DOCUMENTS
 referred to in the
 DEVELOPMENT APPROVAL**



SARA ref: 2201-26844 SDA

Date: 13 June 2022



Vegetation Management Plan

Plan of Area A (Parts A¹ - A¹³) in Lot 308 on Plan GS1041, Lot 22 on Plan GS1042, Lot A on Plan GS885, Lot 33 on Plan SP117630, Lot 015 on Plan CP891307, Lot 0261 on Plan GS804009, Lot 0259 on Plan GS804008, Lot 0258 on Plan GS804007, Lot 1 on Plan AP23197, Lot 2 on Plan AP23197, Lot 261 on Plan GS804009, Lot 259 on Plan GS804008, Lot 258 on Plan GS804007, Lot 170 on Plan GS804007, Lot 15 on Plan CP891307, Lot E on Plan GS804009, Lot 68 on Plan SP111327, Lot 101 on Plan SP111327, Lot 3 on Plan SP302825, Lot X on Plan SP302825, Lot 302 on Plan SP107469, Lot 301 on Plan SP107466, Lot C on Plan GS431, Lot 5 on Plan SP107479, Lot 4 on Plan SP107479, Lot 2 on Plan SP302825, Lot 71 on Plan SP289517, Lot B on Plan GS681 and roads



© The State of Queensland, 2022

VMP
2201-26844 SDA
 Sheet 2 of 7

Version: 2

eLVAS Case ID: 2022/000569

Note: This is a colour plan and should only be reproduced in colour

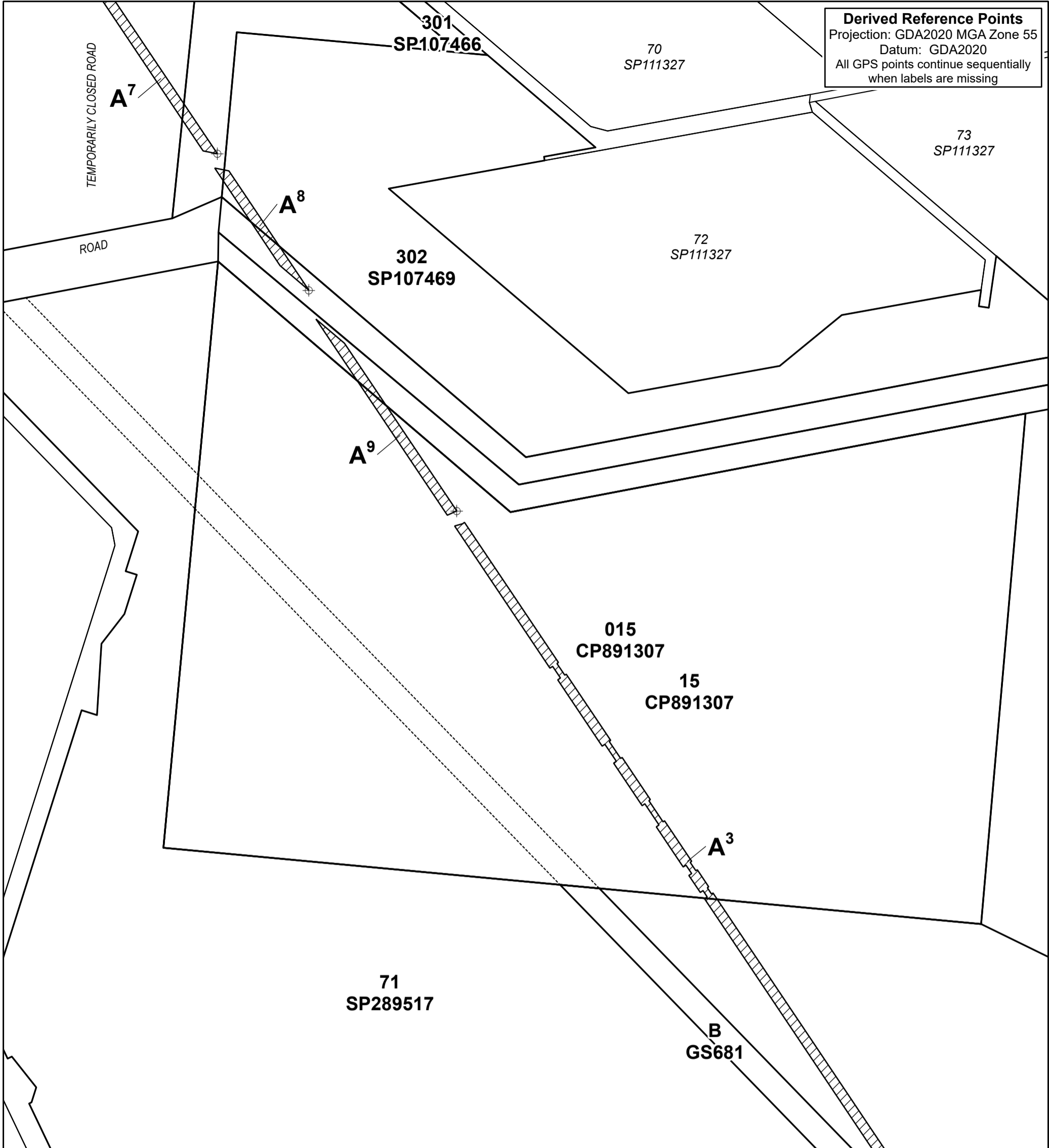

Derived Reference Points
 Projection: GDA2020 MGA Zone 55
 Datum: GDA2020
 All GPS points continue sequentially when labels are missing

1:15000 @ A3 size

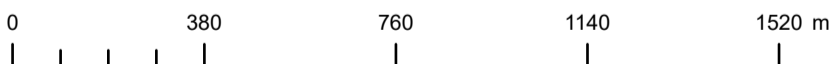

Projection: UTM (MGA Zone 55)

Datum: GDA2020

Notes: Derived Reference Points are provided to assist in the location of area boundaries. Responsibility for locating these boundaries lies solely with the landholder.

Watercourse and drainage feature locations shown on the Vegetation Management Plan are derived from the certified Vegetation Management Watercourse and Drainage Feature Map. These alignments are approximate only and require ground truthing to identify the exact location of the watercourse or drainage feature.

The property boundaries shown on this plan are APPROXIMATE ONLY. They are NOT an accurate representation of the legal boundaries.

This plan must be read in conjunction with conditions attached to 2201-26844 SDA

LEGEND

Derived Reference Start Points (see attachment)

Subject Lot(s)

Area A - Clearing permitted

PLANS AND DOCUMENTS referred to in the DEVELOPMENT APPROVAL

SARA ref: 2201-26844 SDA
 Date: 13 June 2022



Vegetation Management Plan

Plan of Area A (Parts A¹ - A¹³) in Lot 308 on Plan GS1041, Lot 22 on Plan GS1042, Lot A on Plan GS885, Lot 33 on Plan SP117630, Lot 015 on Plan CP891307, Lot 0261 on Plan GS804009, Lot 0259 on Plan GS804008, Lot 0258 on Plan GS804007, Lot 1 on Plan AP23197, Lot 2 on Plan AP23197, Lot 261 on Plan GS804009, Lot 259 on Plan GS804008, Lot 258 on Plan GS804007, Lot 170 on Plan GS804007, Lot 15 on Plan CP891307, Lot E on Plan GS804009, Lot 68 on Plan SP111327, Lot 101 on Plan SP111327, Lot 3 on Plan SP302825, Lot X on Plan SP302825, Lot 302 on Plan SP107469, Lot 301 on Plan SP107466, Lot C on Plan GS431, Lot 5 on Plan SP107479, Lot 4 on Plan SP107479, Lot 2 on Plan SP302825, Lot 71 on Plan SP289517, Lot B on Plan GS681 and roads



© The State of Queensland, 2022

VMP
2201-26844 SDA
 Sheet 3 of 7

Version: 2

eLVAS Case ID: 2022/000569

Note: This is a colour plan and should only be reproduced in colour

Derived Reference Points
 Projection: GDA2020 MGA Zone 55
 Datum: GDA2020
 All GPS points continue sequentially when labels are missing

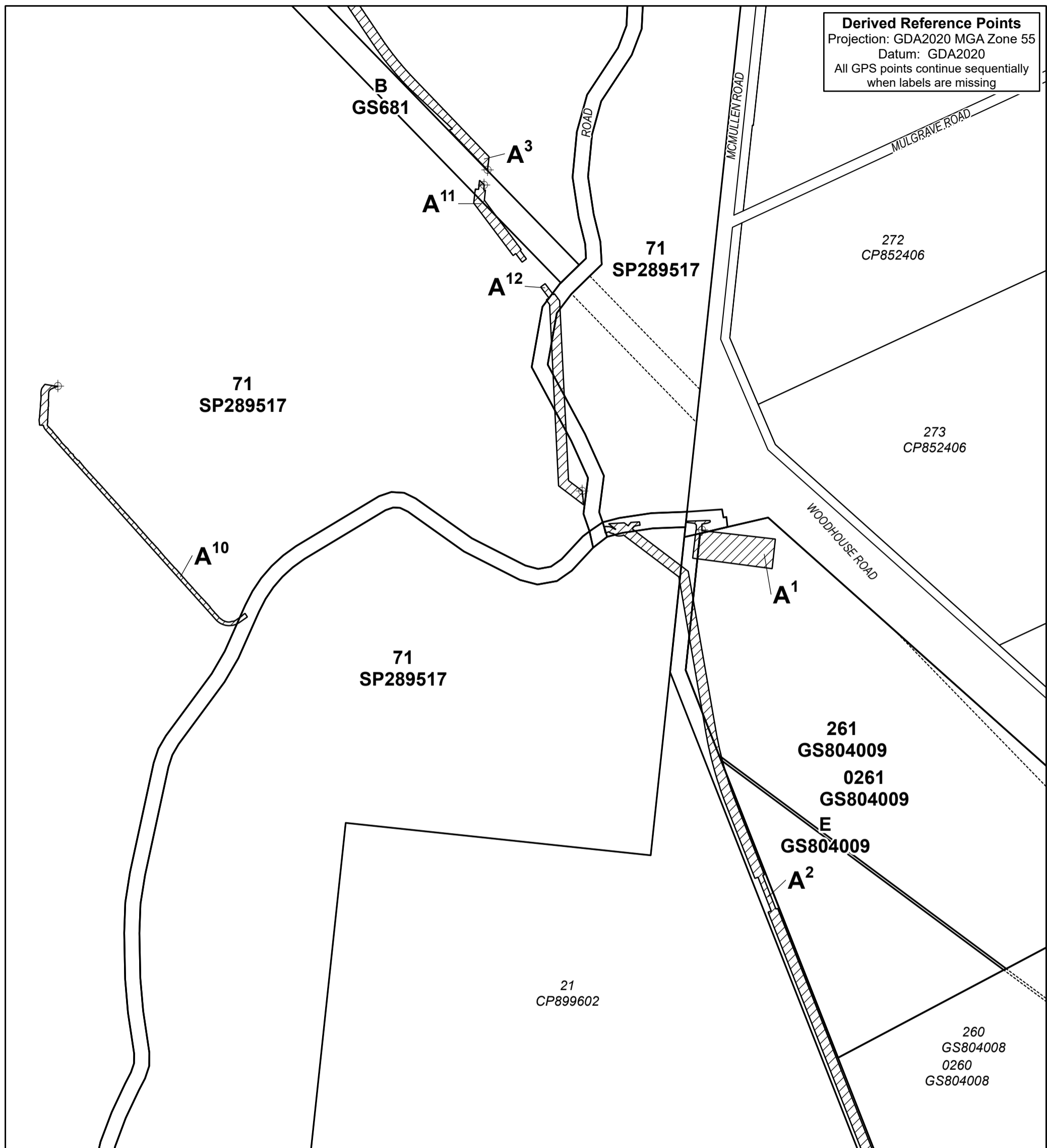

1:15000 @ A3 size

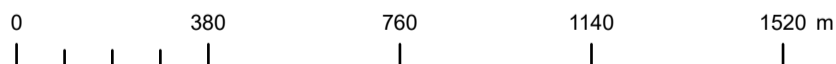

Projection: UTM (MGA Zone 55)

Datum: GDA2020

Notes: Derived Reference Points are provided to assist in the location of area boundaries. Responsibility for locating these boundaries lies solely with the landholder.

Watercourse and drainage feature locations shown on the Vegetation Management Plan are derived from the certified Vegetation Management Watercourse and Drainage Feature Map. These alignments are approximate only and require ground truthing to identify the exact location of the watercourse or drainage feature.

The property boundaries shown on this plan are APPROXIMATE ONLY. They are NOT an accurate representation of the legal boundaries.

This plan must be read in conjunction with conditions attached to 2201-26844 SDA

LEGEND

Derived Reference Start Points (see attachment)

Subject Lot(s)

Area A - Clearing permitted

PLANS AND DOCUMENTS referred to in the DEVELOPMENT APPROVAL

SARA ref: 2201-26844 SDA
 Date: 13 June 2022



Vegetation Management Plan

Plan of Area A (Parts A¹ - A¹³) in Lot 308 on Plan GS1041, Lot 22 on Plan GS1042, Lot A on Plan GS885, Lot 33 on Plan SP117630, Lot 015 on Plan CP891307, Lot 0261 on Plan GS804009, Lot 0259 on Plan GS804008, Lot 0258 on Plan GS804007, Lot 1 on Plan AP23197, Lot 2 on Plan AP23197, Lot 261 on Plan GS804009, Lot 259 on Plan GS804008, Lot 258 on Plan GS804007, Lot 170 on Plan GS804007, Lot 15 on Plan CP891307, Lot E on Plan GS804009, Lot 68 on Plan SP111327, Lot 101 on Plan SP111327, Lot 3 on Plan SP302825, Lot X on Plan SP302825, Lot 302 on Plan SP107469, Lot 301 on Plan SP107466, Lot C on Plan GS431, Lot 5 on Plan SP107479, Lot 4 on Plan SP107479, Lot 2 on Plan SP302825, Lot 71 on Plan SP289517, Lot B on Plan GS681 and roads



© The State of Queensland, 2022

VMP
2201-26844 SDA
 Sheet 4 of 7

Version: 2

eLVAS Case ID: 2022/000569

Note: This is a colour plan and should only be reproduced in colour

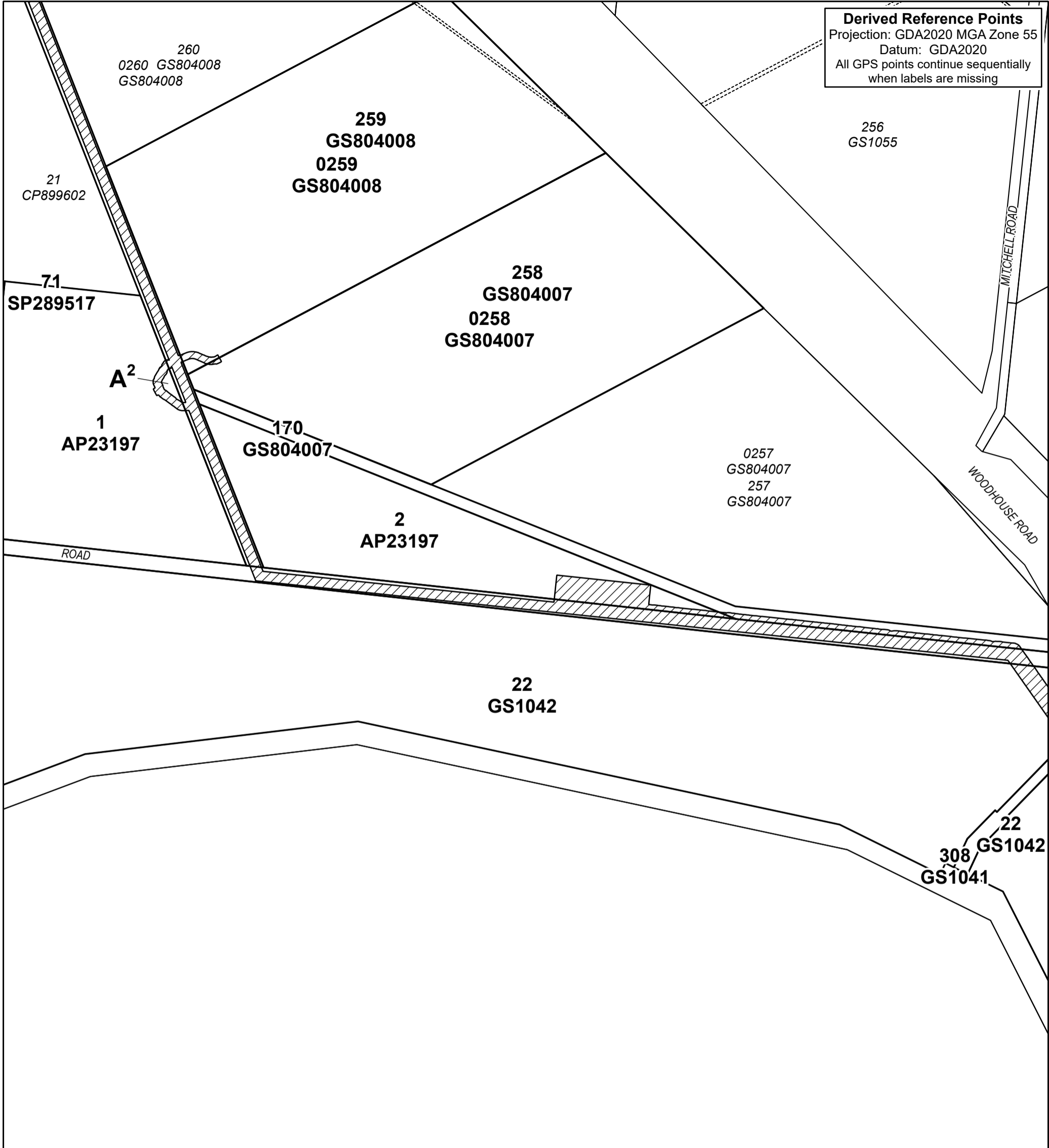

Derived Reference Points
 Projection: GDA2020 MGA Zone 55
 Datum: GDA2020
 All GPS points continue sequentially when labels are missing

1:15000 @ A3 size

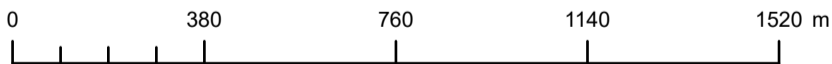

Projection: UTM (MGA Zone 55) Datum: GDA2020

Notes: Derived Reference Points are provided to assist in the location of area boundaries. Responsibility for locating these boundaries lies solely with the landholder.

Watercourse and drainage feature locations shown on the Vegetation Management Plan are derived from the certified Vegetation Management Watercourse and Drainage Feature Map. These alignments are approximate only and require ground truthing to identify the exact location of the watercourse or drainage feature.

The property boundaries shown on this plan are APPROXIMATE ONLY. They are NOT an accurate representation of the legal boundaries.

This plan must be read in conjunction with conditions attached to 2201-26844 SDA

LEGEND

Derived Reference Start Points (see attachment)

Subject Lot(s)

Area A - Clearing permitted

PLANS AND DOCUMENTS referred to in the DEVELOPMENT APPROVAL

SARA ref: 2201-26844 SDA
 Date: 13 June 2022



Vegetation Management Plan

Plan of Area A (Parts A¹ - A¹³) in Lot 308 on Plan GS1041, Lot 22 on Plan GS1042, Lot A on Plan GS885, Lot 33 on Plan SP117630, Lot 015 on Plan CP891307, Lot 0261 on Plan GS804009, Lot 0259 on Plan GS804008, Lot 0258 on Plan GS804007, Lot 1 on Plan AP23197, Lot 2 on Plan AP23197, Lot 261 on Plan GS804009, Lot 259 on Plan GS804008, Lot 258 on Plan GS804007, Lot 170 on Plan GS804007, Lot 15 on Plan CP891307, Lot E on Plan GS804009, Lot 68 on Plan SP111327, Lot 101 on Plan SP111327, Lot 3 on Plan SP302825, Lot X on Plan SP302825, Lot 302 on Plan SP107469, Lot 301 on Plan SP107466, Lot C on Plan GS431, Lot 5 on Plan SP107479, Lot 4 on Plan SP107479, Lot 2 on Plan SP302825, Lot 71 on Plan SP289517, Lot B on Plan GS681 and roads



© The State of Queensland, 2022

VMP
2201-26844 SDA
 Sheet 5 of 7

Version: 2

eLVAS Case ID: 2022/000569

Note: This is a colour plan and should only be reproduced in colour

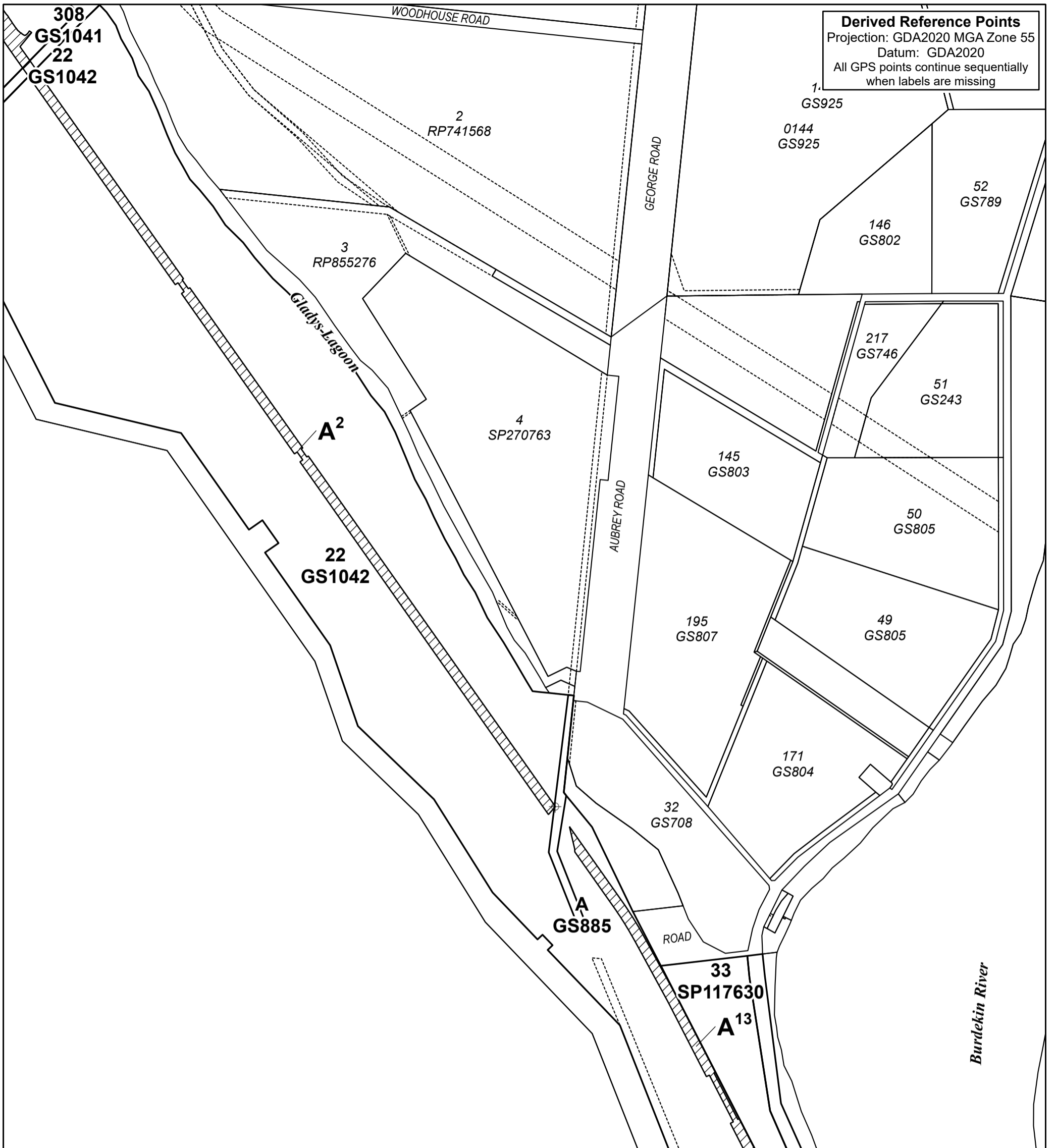

Derived Reference Points
 Projection: GDA2020 MGA Zone 55
 Datum: GDA2020
 All GPS points continue sequentially when labels are missing

1:15000 @ A3 size

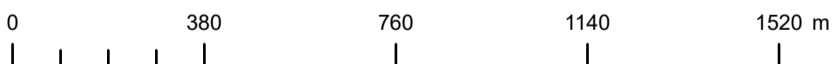

Projection: UTM (MGA Zone 55)

Datum: GDA2020

Notes: Derived Reference Points are provided to assist in the location of area boundaries. Responsibility for locating these boundaries lies solely with the landholder.

Watercourse and drainage feature locations shown on the Vegetation Management Plan are derived from the certified Vegetation Management Watercourse and Drainage Feature Map. These alignments are approximate only and require ground truthing to identify the exact location of the watercourse or drainage feature.

The property boundaries shown on this plan are APPROXIMATE ONLY. They are NOT an accurate representation of the legal boundaries.

This plan must be read in conjunction with conditions attached to 2201-26844 SDA

LEGEND

Derived Reference Start Points (see attachment)

Subject Lot(s)

Area A - Clearing permitted

PLANS AND DOCUMENTS referred to in the DEVELOPMENT APPROVAL

SARA ref: 2201-26844 SDA

Date: 13 June 2022

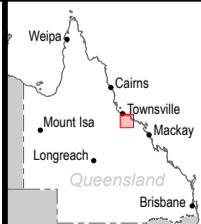

Vegetation Management Plan

Plan of Area A (Parts A¹ - A¹³) in Lot 308 on Plan GS1041, Lot 22 on Plan GS1042, Lot A on Plan GS885, Lot 33 on Plan SP117630, Lot 015 on Plan CP891307, Lot 0261 on Plan GS804009, Lot 0259 on Plan GS804008, Lot 0258 on Plan GS804007, Lot 1 on Plan AP23197, Lot 2 on Plan AP23197, Lot 261 on Plan GS804009, Lot 259 on Plan GS804008, Lot 258 on Plan GS804007, Lot 170 on Plan GS804007, Lot 15 on Plan CP891307, Lot E on Plan GS804009, Lot 68 on Plan SP111327, Lot 101 on Plan SP111327, Lot 3 on Plan SP302825, Lot X on Plan SP302825, Lot 302 on Plan SP107469, Lot 301 on Plan SP107466, Lot C on Plan GS431, Lot 5 on Plan SP107479, Lot 4 on Plan SP107479, Lot 2 on Plan SP302825, Lot 71 on Plan SP289517, Lot B on Plan GS681 and roads



© The State of Queensland, 2022

VMP
2201-26844 SDA
 Sheet 6 of 7

Version: 2

eLVAS Case ID: 2022/000569

Note: This is a colour plan and should only be reproduced in colour

Derived Reference Points
 Projection: GDA2020 MGA Zone 55
 Datum: GDA2020
 All GPS points continue sequentially when labels are missing

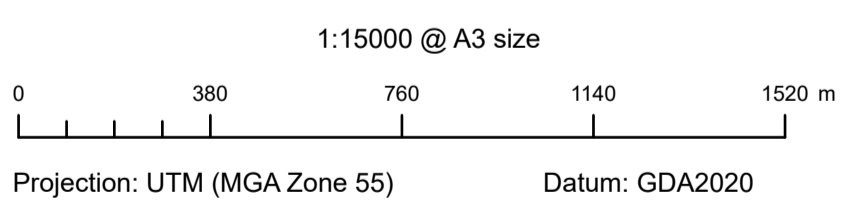
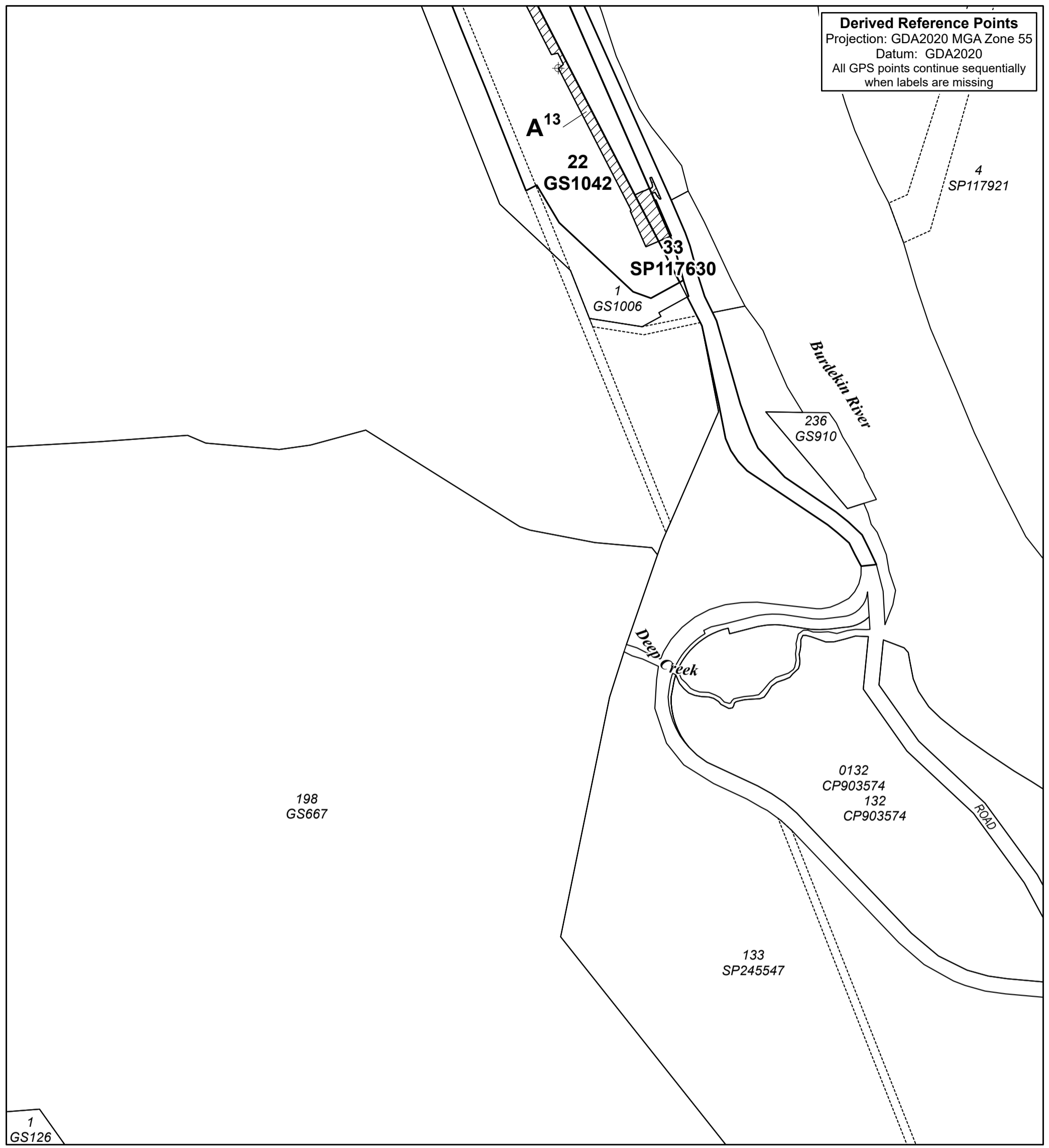

Notes: Derived Reference Points are provided to assist in the location of area boundaries. Responsibility for locating these boundaries lies solely with the landholder.
 Watercourse and drainage feature locations shown on the Vegetation Management Plan are derived from the certified Vegetation Management Watercourse and Drainage Feature Map. These alignments are approximate only and require ground truthing to identify the exact location of the watercourse or drainage feature.
 The property boundaries shown on this plan are APPROXIMATE ONLY. They are NOT an accurate representation of the legal boundaries.

This plan must be read in conjunction with conditions attached to 2201-26844 SDA

LEGEND

- Derived Reference Start Points (see attachment)
- Subject Lot(s)
- Area A - Clearing permitted

PLANS AND DOCUMENTS referred to in the DEVELOPMENT APPROVAL

SARA ref: 2201-26844 SDA

Date: 13 June 2022

Note: This is a colour plan and should only be reproduced in colour

Vegetation Management Plan

Plan of Area A (Parts A¹ - A¹³) in Lot 308 on Plan GS1041, Lot 22 on Plan GS1042, Lot A on Plan GS885, Lot 33 on Plan SP117630, Lot 015 on Plan CP891307, Lot 0261 on Plan GS804009, Lot 0259 on Plan GS804008, Lot 0258 on Plan GS804007, Lot 1 on Plan AP23197, Lot 2 on Plan AP23197, Lot 261 on Plan GS804009, Lot 259 on Plan GS804008, Lot 258 on Plan GS804007, Lot 170 on Plan GS804007, Lot 15 on Plan CP891307, Lot E on Plan GS804009, Lot 68 on Plan SP111327, Lot 101 on Plan SP111327, Lot 3 on Plan SP302825, Lot X on Plan SP302825, Lot 302 on Plan SP107469, Lot 301 on Plan SP107466, Lot C on Plan GS431, Lot 5 on Plan SP107479, Lot 4 on Plan SP107479, Lot 2 on Plan SP302825, Lot 71 on Plan SP289517, Lot B on Plan GS681 and roads

Version: 2 eLVAS Case ID: 2022/000569

© The State of Queensland, 2022

VMP

2201-26844 SDA

Sheet 7 of 7

**Attachment to Plan: 2201-26844 SDA
Derived Reference Points
Datum: GDA2020, Projection: MGA Zone 55**

**PLANS AND DOCUMENTS
referred to in the
DEVELOPMENT APPROVAL**



SARA ref: 2201-26844 SDA

Date: 13 June 2022

Notes: Derived Reference Points are provided to assist in the location of area boundaries.
Responsibility for locating these boundaries lies solely with the landholder and delegated contractor(s).
Coordinates start at a point indicated on the accompanying plan and proceed in a clockwise direction.

Part ID	Unique ID	Easting	Northing
A1	1	514744	7806986
A1	2	514743	7806982
A1	3	515033	7806949
A1	4	515020	7806832
A1	5	514707	7806874
A1	6	514721	7806985
A1	7	514722	7806985
A1	8	514722	7806992
A1	9	514722	7807004
A1	10	514716	7807011
A1	11	514703	7807012
A1	12	514683	7807015
A1	13	514684	7807019
A1	14	514749	7807021
A1	15	514758	7807022
A1	16	514776	7807022
A1	17	514777	7807017
A1	18	514775	7807015
A1	19	514767	7807012
A1	20	514744	7807008
A1	21	514744	7806986
A2	22	521526	7798749
A2	23	521521	7798744
A2	24	521499	7798718
A2	25	520523	7800104
A2	26	520533	7800112
A2	27	520511	7800143
A2	28	520501	7800135
A2	29	520057	7800766
A2	30	520067	7800773
A2	31	520043	7800808
A2	32	520032	7800801
A2	33	519448	7801630
A2	34	519425	7801663
A2	35	519398	7801701
A2	36	519395	7801706
A2	37	519370	7801741
A2	38	519284	7801864
A2	39	519210	7801968
A2	40	519207	7801972
A2	41	516283	7802281
A2	42	516259	7802284
A2	43	515997	7802952
A2	44	515993	7802952
A2	45	515988	7802952
A2	46	515983	7802952
A2	47	515978	7802952
A2	48	515973	7802952
A2	49	515971	7802952
A2	50	515969	7802952
A2	51	515967	7802952
A2	52	515964	7802952
A2	53	515962	7802953
A2	54	515960	7802953
A2	55	515958	7802954
A2	56	515956	7802955
A2	57	515954	7802956
A2	58	515952	7802957
A2	59	515950	7802959
A2	60	515950	7802959

Part ID	Unique ID	Easting	Northing
A2	61	515946	7802962
A2	62	515942	7802965
A2	63	515938	7802968
A2	64	515934	7802970
A2	65	515930	7802973
A2	66	515926	7802977
A2	67	515922	7802979
A2	68	515918	7802982
A2	69	515914	7802985
A2	70	515910	7802988
A2	71	515906	7802991
A2	72	515902	7802994
A2	73	515898	7802996
A2	74	515893	7802999
A2	75	515889	7803002
A2	76	515885	7803005
A2	77	515885	7803005
A2	78	515883	7803007
A2	79	515881	7803009
A2	80	515880	7803010
A2	81	515879	7803011
A2	82	515878	7803013
A2	83	515877	7803013
A2	84	515871	7803010
A2	85	515869	7803014
A2	86	515860	7803031
A2	87	515857	7803036
A2	88	515865	7803041
A2	89	515864	7803042
A2	90	515862	7803047
A2	91	515860	7803050
A2	92	515860	7803050
A2	93	515859	7803052
A2	94	515858	7803054
A2	95	515857	7803057
A2	96	515857	7803059
A2	97	515857	7803061
A2	98	515857	7803063
A2	99	515857	7803066
A2	100	515857	7803068
A2	101	515857	7803071
A2	102	515859	7803075
A2	103	515861	7803076
A2	104	515861	7803076
A2	105	515861	7803079
A2	106	515861	7803081
A2	107	515862	7803085
A2	108	515865	7803090
A2	109	515868	7803094
A2	110	515870	7803099
A2	111	515874	7803103
A2	112	515876	7803107
A2	113	515878	7803110
A2	114	515880	7803115
A2	115	515884	7803121
A2	116	515889	7803124
A2	117	515891	7803126
A2	118	515891	7803131
A2	119	515892	7803133
A2	120	515892	7803133

Part ID	Unique ID	Easting	Northing
A2	121	515895	7803138
A2	122	515897	7803138
A2	123	515897	7803141
A2	124	515900	7803144
A2	125	515902	7803146
A2	126	515905	7803148
A2	127	515907	7803148
A2	128	515908	7803148
A2	129	515908	7803149
A2	130	515910	7803150
A2	131	515915	7803151
A2	132	515918	7803152
A2	133	515920	7803148
A2	134	515920	7803148
A2	135	515920	7803149
A2	136	515004	7805480
A2	137	515017	7805485
A2	138	514964	7805618
A2	139	514952	7805613
A2	140	514843	7805891
A2	141	514839	7805903
A2	142	514834	7805916
A2	143	514829	7805928
A2	144	514825	7805940
A2	145	514820	7805953
A2	146	514816	7805965
A2	147	514812	7805978
A2	148	514808	7805990
A2	149	514804	7806003
A2	150	514800	7806015
A2	151	514796	7806028
A2	152	514793	7806041
A2	153	514789	7806053
A2	154	514786	7806066
A2	155	514783	7806079
A2	156	514779	7806092
A2	157	514776	7806104
A2	158	514773	7806117
A2	159	514771	7806130
A2	160	514768	7806143
A2	161	514765	7806156
A2	162	514763	7806169
A2	163	514760	7806182
A2	164	514737	7806316
A2	165	514692	7806575
A2	166	514663	7806743
A2	167	514655	7806789
A2	168	514653	7806800
A2	169	514436	7806965
A2	170	514431	7806963
A2	171	514426	7806962
A2	172	514424	7806962
A2	173	514423	7806961
A2	174	514421	7806961
A2	175	514420	7806961
A2	176	514418	7806961
A2	177	514416	7806961
A2	178	514414	7806961
A2	179	514412	7806961
A2	180	514410	7806962

Attachment to Plan: 2201-26844 SDA
Derived Reference Points
Datum: GDA2020, Projection: MGA Zone 55

PLANS AND DOCUMENTS
referred to in the
DEVELOPMENT APPROVAL



SARA ref: 2201-26844 SDA

Date: 13 June 2022

Notes: Derived Reference Points are provided to assist in the location of area boundaries.
 Responsibility for locating these boundaries lies solely with the landholder and delegated contractor(s).
 Coordinates start at a point indicated on the accompanying plan and proceed in a clockwise direction.

Part ID	Unique ID	Easting	Northing
A2	181	514408	7806962
A2	182	514407	7806963
A2	183	514406	7806963
A2	184	514405	7806964
A2	185	514404	7806964
A2	186	514400	7806966
A2	187	514397	7806970
A2	188	514391	7806971
A2	189	514386	7806972
A2	190	514382	7806975
A2	191	514380	7806975
A2	192	514380	7806975
A2	193	514380	7806976
A2	194	514379	7806976
A2	195	514379	7806977
A2	196	514378	7806977
A2	197	514378	7806978
A2	198	514377	7806978
A2	199	514377	7806978
A2	200	514376	7806977
A2	201	514376	7806977
A2	202	514375	7806977
A2	203	514375	7806977
A2	204	514370	7806975
A2	205	514366	7806974
A2	206	514363	7806973
A2	207	514359	7806996
A2	208	514361	7806996
A2	209	514366	7806999
A2	210	514371	7806998
A2	211	514371	7806998
A2	212	514373	7806998
A2	213	514375	7806998
A2	214	514377	7806998
A2	215	514379	7806998
A2	216	514381	7806998
A2	217	514382	7806997
A2	218	514384	7806997
A2	219	514386	7806996
A2	220	514388	7806995
A2	221	514389	7806995
A2	222	514391	7806994
A2	223	514392	7806993
A2	224	514396	7806990
A2	225	514400	7806988
A2	226	514406	7806987
A2	227	514406	7806987
A2	228	514376	7807009
A2	229	514421	7807012
A2	230	514438	7807013
A2	231	514454	7807001
A2	232	514455	7807003
A2	233	514457	7807006
A2	234	514458	7807007
A2	235	514459	7807008
A2	236	514460	7807010
A2	237	514462	7807011
A2	238	514463	7807012
A2	239	514463	7807014
A2	240	514498	7807016

Part ID	Unique ID	Easting	Northing
A2	241	514500	7807003
A2	242	514495	7807003
A2	243	514490	7807002
A2	244	514485	7807001
A2	245	514480	7807000
A2	246	514479	7807000
A2	247	514479	7807000
A2	248	514479	7807000
A2	249	514478	7807000
A2	250	514477	7806999
A2	251	514477	7806999
A2	252	514476	7806998
A2	253	514476	7806998
A2	254	514475	7806997
A2	255	514475	7806996
A2	256	514475	7806996
A2	257	514475	7806995
A2	258	514474	7806995
A2	259	514474	7806995
A2	260	514472	7806995
A2	261	514471	7806993
A2	262	514469	7806989
A2	263	514484	7806978
A2	264	514661	7806844
A2	265	514690	7806822
A2	266	514703	7806750
A2	267	514708	7806720
A2	268	514800	7806189
A2	269	514802	7806176
A2	270	514805	7806164
A2	271	514812	7806124
A2	272	514813	7806122
A2	273	514818	7806101
A2	274	514821	7806089
A2	275	514825	7806076
A2	276	514828	7806064
A2	277	514831	7806051
A2	278	514835	7806039
A2	279	514838	7806027
A2	280	514842	7806015
A2	281	514846	7806002
A2	282	514850	7805990
A2	283	514854	7805978
A2	284	514858	7805966
A2	285	514862	7805954
A2	286	514867	7805942
A2	287	514871	7805930
A2	288	514876	7805918
A2	289	514881	7805906
A2	290	514990	7805628
A2	291	514983	7805625
A2	292	515035	7805493
A2	293	515042	7805495
A2	294	515956	7803167
A2	295	515959	7803168
A2	296	515959	7803168
A2	297	515959	7803168
A2	298	515960	7803168
A2	299	515960	7803168
A2	300	515960	7803168

Part ID	Unique ID	Easting	Northing
A2	301	515960	7803168
A2	302	515961	7803168
A2	303	515961	7803168
A2	304	515961	7803168
A2	305	515962	7803168
A2	306	515962	7803168
A2	307	515966	7803170
A2	308	515970	7803172
A2	309	515975	7803173
A2	310	515980	7803175
A2	311	515984	7803177
A2	312	515986	7803178
A2	313	515988	7803179
A2	314	515990	7803179
A2	315	515992	7803180
A2	316	515994	7803181
A2	317	515996	7803181
A2	318	515998	7803181
A2	319	516000	7803182
A2	320	516002	7803182
A2	321	516004	7803182
A2	322	516006	7803182
A2	323	516008	7803183
A2	324	516010	7803183
A2	325	516012	7803183
A2	326	516015	7803183
A2	327	516017	7803182
A2	328	516019	7803182
A2	329	516021	7803182
A2	330	516023	7803181
A2	331	516025	7803181
A2	332	516027	7803180
A2	333	516029	7803180
A2	334	516031	7803179
A2	335	516033	7803179
A2	336	516035	7803178
A2	337	516039	7803176
A2	338	516043	7803174
A2	339	516047	7803172
A2	340	516052	7803171
A2	341	516057	7803169
A2	342	516062	7803166
A2	343	516066	7803165
A2	344	516070	7803163
A2	345	516071	7803163
A2	346	516073	7803163
A2	347	516074	7803162
A2	348	516075	7803162
A2	349	516075	7803162
A2	350	516076	7803162
A2	351	516078	7803161
A2	352	516079	7803161
A2	353	516082	7803161
A2	354	516083	7803160
A2	355	516083	7803160
A2	356	516084	7803161
A2	357	516087	7803161
A2	358	516088	7803161
A2	359	516089	7803161
A2	360	516091	7803162

Attachment to Plan: 2201-26844 SDA
Derived Reference Points
Datum: GDA2020, Projection: MGA Zone 55

PLANS AND DOCUMENTS
referred to in the
DEVELOPMENT APPROVAL



SARA ref: 2201-26844 SDA

Date: 13 June 2022

Notes: Derived Reference Points are provided to assist in the location of area boundaries.
Responsibility for locating these boundaries lies solely with the landholder and delegated contractor(s).
Coordinates start at a point indicated on the accompanying plan and proceed in a clockwise direction.

Part ID	Unique ID	Easting	Northing
A2	361	516093	7803161
A2	362	516094	7803161
A2	363	516094	7803161
A2	364	516095	7803162
A2	365	516096	7803162
A2	366	516097	7803163
A2	367	516098	7803163
A2	368	516100	7803164
A2	369	516101	7803164
A2	370	516102	7803165
A2	371	516102	7803165
A2	372	516106	7803167
A2	373	516110	7803170
A2	374	516113	7803165
A2	375	516122	7803148
A2	376	516125	7803143
A2	377	516120	7803141
A2	378	516117	7803139
A2	379	516116	7803138
A2	380	516114	7803137
A2	381	516112	7803136
A2	382	516110	7803136
A2	383	516108	7803135
A2	384	516105	7803134
A2	385	516101	7803134
A2	386	516100	7803135
A2	387	516097	7803134
A2	388	516095	7803134
A2	389	516094	7803134
A2	390	516091	7803133
A2	391	516089	7803133
A2	392	516087	7803132
A2	393	516085	7803132
A2	394	516082	7803132
A2	395	516080	7803132
A2	396	516078	7803133
A2	397	516076	7803133
A2	398	516074	7803133
A2	399	516072	7803134
A2	400	516070	7803134
A2	401	516068	7803135
A2	402	516067	7803135
A2	403	516066	7803135
A2	404	516064	7803136
A2	405	516063	7803136
A2	406	516060	7803136
A2	407	516059	7803137
A2	408	516055	7803140
A2	409	516051	7803141
A2	410	516046	7803143
A2	411	516041	7803145
A2	412	516037	7803147
A2	413	516032	7803149
A2	414	516028	7803151
A2	415	516024	7803153
A2	416	516023	7803153
A2	417	516022	7803153
A2	418	516021	7803154
A2	419	516020	7803154
A2	420	516019	7803155

Part ID	Unique ID	Easting	Northing
A2	421	516018	7803155
A2	422	516016	7803155
A2	423	516015	7803155
A2	424	516014	7803155
A2	425	516013	7803156
A2	426	516012	7803156
A2	427	516010	7803156
A2	428	516009	7803156
A2	429	516008	7803156
A2	430	516007	7803155
A2	431	516005	7803155
A2	432	516004	7803155
A2	433	516003	7803155
A2	434	516002	7803155
A2	435	516001	7803154
A2	436	515999	7803154
A2	437	515998	7803154
A2	438	515997	7803153
A2	439	515996	7803153
A2	440	515994	7803152
A2	441	515990	7803150
A2	442	515985	7803149
A2	443	515981	7803147
A2	444	515976	7803145
A2	445	515972	7803143
A2	446	515971	7803143
A2	447	515967	7803141
A2	448	515966	7803141
A2	449	516287	7802321
A2	450	517428	7802201
A2	451	517439	7802306
A2	452	517807	7802267
A2	453	517802	7802219
A2	454	517799	7802191
A2	455	517802	7802191
A2	456	517807	7802190
A2	457	517812	7802189
A2	458	517816	7802189
A2	459	517822	7802189
A2	460	517827	7802189
A2	461	517829	7802188
A2	462	517832	7802188
A2	463	517837	7802187
A2	464	517841	7802187
A2	465	517844	7802187
A2	466	517844	7802187
A2	467	517847	7802186
A2	468	517852	7802185
A2	469	517856	7802185
A2	470	517862	7802185
A2	471	517867	7802184
A2	472	517872	7802183
A2	473	517877	7802183
A2	474	517881	7802182
A2	475	517884	7802182
A2	476	517886	7802182
A2	477	517891	7802181
A2	478	517896	7802181
A2	479	517902	7802180
A2	480	517906	7802179

Part ID	Unique ID	Easting	Northing
A2	481	517911	7802178
A2	482	517916	7802179
A2	483	517921	7802178
A2	484	517926	7802177
A2	485	517931	7802176
A2	486	517936	7802176
A2	487	517941	7802175
A2	488	517946	7802175
A2	489	517951	7802175
A2	490	517956	7802174
A2	491	517961	7802174
A2	492	517966	7802173
A2	493	517971	7802173
A2	494	517974	7802172
A2	495	517976	7802172
A2	496	517981	7802172
A2	497	517986	7802171
A2	498	517991	7802171
A2	499	517996	7802170
A2	500	518001	7802170
A2	501	518006	7802169
A2	502	518011	7802169
A2	503	518016	7802168
A2	504	518021	7802168
A2	505	518026	7802167
A2	506	518031	7802166
A2	507	518035	7802165
A2	508	518040	7802165
A2	509	518045	7802164
A2	510	518050	7802164
A2	511	518055	7802163
A2	512	518060	7802163
A2	513	518065	7802162
A2	514	518070	7802162
A2	515	518075	7802161
A2	516	518080	7802161
A2	517	518085	7802160
A2	518	518090	7802160
A2	519	518095	7802159
A2	520	518100	7802159
A2	521	518104	7802158
A2	522	518106	7802159
A2	523	518109	7802159
A2	524	518115	7802159
A2	525	518119	7802159
A2	526	518121	7802159
A2	527	518125	7802157
A2	528	518130	7802157
A2	529	518135	7802157
A2	530	518140	7802156
A2	531	518145	7802155
A2	532	518150	7802154
A2	533	518155	7802154
A2	534	518160	7802153
A2	535	518165	7802152
A2	536	518170	7802152
A2	537	518175	7802152
A2	538	518180	7802151
A2	539	518185	7802150
A2	540	518190	7802150

**Attachment to Plan: 2201-26844 SDA
Derived Reference Points
Datum: GDA2020, Projection: MGA Zone 55**

**PLANS AND DOCUMENTS
referred to in the
DEVELOPMENT APPROVAL**



SARA ref: 2201-26844 SDA

Date: 13 June 2022

Notes: Derived Reference Points are provided to assist in the location of area boundaries.
Responsibility for locating these boundaries lies solely with the landholder and delegated contractor(s).
Coordinates start at a point indicated on the accompanying plan and proceed in a clockwise direction.

Part ID	Unique ID	Easting	Northing
A2	541	518195	7802149
A2	542	518200	7802149
A2	543	518204	7802148
A2	544	518210	7802148
A2	545	518214	7802147
A2	546	518219	7802147
A2	547	518224	7802146
A2	548	518230	7802146
A2	549	518234	7802145
A2	550	518239	7802145
A2	551	518244	7802144
A2	552	518249	7802144
A2	553	518254	7802143
A2	554	518259	7802143
A2	555	518264	7802142
A2	556	518269	7802142
A2	557	518274	7802141
A2	558	518279	7802141
A2	559	518284	7802140
A2	560	518289	7802139
A2	561	518294	7802139
A2	562	518299	7802139
A2	563	518304	7802138
A2	564	518309	7802137
A2	565	518314	7802137
A2	566	518319	7802136
A2	567	518324	7802136
A2	568	518329	7802135
A2	569	518334	7802135
A2	570	518339	7802134
A2	571	518344	7802134
A2	572	518349	7802133
A2	573	518353	7802133
A2	574	518359	7802133
A2	575	518364	7802132
A2	576	518369	7802131
A2	577	518373	7802131
A2	578	518379	7802130
A2	579	518384	7802130
A2	580	518385	7802130
A2	581	518389	7802129
A2	582	518394	7802129
A2	583	518398	7802128
A2	584	518404	7802128
A2	585	518409	7802127
A2	586	518413	7802126
A2	587	518418	7802126
A2	588	518423	7802125
A2	589	518428	7802125
A2	590	518433	7802124
A2	591	518438	7802124
A2	592	518443	7802124
A2	593	518448	7802123
A2	594	518453	7802122
A2	595	518458	7802122
A2	596	518463	7802121
A2	597	518468	7802121
A2	598	518473	7802120
A2	599	518478	7802120
A2	600	518483	7802119

Part ID	Unique ID	Easting	Northing
A2	601	518488	7802119
A2	602	518493	7802118
A2	603	518498	7802118
A2	604	518503	7802117
A2	605	518508	7802117
A2	606	518513	7802116
A2	607	518518	7802116
A2	608	518523	7802115
A2	609	518528	7802114
A2	610	518533	7802114
A2	611	518538	7802113
A2	612	518543	7802113
A2	613	518548	7802112
A2	614	518553	7802111
A2	615	518558	7802111
A2	616	518561	7802110
A2	617	518562	7802110
A2	618	518568	7802110
A2	619	518573	7802109
A2	620	518577	7802109
A2	621	518582	7802108
A2	622	518587	7802108
A2	623	518593	7802107
A2	624	518597	7802106
A2	625	518602	7802106
A2	626	518607	7802105
A2	627	518612	7802105
A2	628	518617	7802104
A2	629	518622	7802104
A2	630	518627	7802104
A2	631	518632	7802103
A2	632	518637	7802102
A2	633	518642	7802102
A2	634	518647	7802101
A2	635	518652	7802100
A2	636	518657	7802100
A2	637	518662	7802099
A2	638	518667	7802099
A2	639	518672	7802098
A2	640	518677	7802098
A2	641	518682	7802097
A2	642	518687	7802097
A2	643	518692	7802096
A2	644	518697	7802096
A2	645	518702	7802095
A2	646	518707	7802094
A2	647	518711	7802094
A2	648	518716	7802094
A2	649	518721	7802094
A2	650	518727	7802093
A2	651	518732	7802093
A2	652	518737	7802092
A2	653	518743	7802090
A2	654	518747	7802087
A2	655	518751	7802087
A2	656	518755	7802087
A2	657	518760	7802088
A2	658	518766	7802088
A2	659	518771	7802088
A2	660	518776	7802088

Part ID	Unique ID	Easting	Northing
A2	661	518781	7802087
A2	662	518786	7802087
A2	663	518791	7802086
A2	664	518796	7802085
A2	665	518801	7802084
A2	666	518806	7802084
A2	667	518811	7802083
A2	668	518816	7802083
A2	669	518821	7802082
A2	670	518826	7802082
A2	671	518831	7802082
A2	672	518836	7802081
A2	673	518841	7802080
A2	674	518846	7802080
A2	675	518851	7802079
A2	676	518856	7802079
A2	677	518861	7802078
A2	678	518866	7802078
A2	679	518871	7802077
A2	680	518876	7802077
A2	681	518881	7802076
A2	682	518886	7802076
A2	683	518890	7802075
A2	684	518896	7802075
A2	685	518901	7802074
A2	686	518906	7802073
A2	687	518910	7802073
A2	688	518916	7802073
A2	689	518920	7802072
A2	690	518925	7802072
A2	691	518931	7802071
A2	692	518936	7802070
A2	693	518940	7802070
A2	694	518945	7802070
A2	695	518950	7802069
A2	696	518955	7802069
A2	697	518960	7802068
A2	698	518965	7802067
A2	699	518970	7802067
A2	700	518975	7802067
A2	701	518980	7802066
A2	702	518985	7802065
A2	703	518990	7802065
A2	704	518995	7802064
A2	705	519000	7802064
A2	706	519005	7802063
A2	707	519010	7802062
A2	708	519015	7802062
A2	709	519020	7802061
A2	710	519025	7802061
A2	711	519030	7802060
A2	712	519035	7802060
A2	713	519040	7802059
A2	714	519045	7802059
A2	715	519050	7802059
A2	716	519055	7802058
A2	717	519060	7802058
A2	718	519065	7802057
A2	719	519070	7802056
A2	720	519075	7802056

**Attachment to Plan: 2201-26844 SDA
Derived Reference Points
Datum: GDA2020, Projection: MGA Zone 55**

**PLANS AND DOCUMENTS
referred to in the
DEVELOPMENT APPROVAL**



SARA ref: 2201-26844 SDA

Date: 13 June 2022

Notes: Derived Reference Points are provided to assist in the location of area boundaries.
Responsibility for locating these boundaries lies solely with the landholder and delegated contractor(s).
Coordinates start at a point indicated on the accompanying plan and proceed in a clockwise direction.

Part ID	Unique ID	Easting	Northing
A2	721	519080	7802055
A2	722	519085	7802055
A2	723	519089	7802054
A2	724	519094	7802054
A2	725	519100	7802053
A2	726	519104	7802053
A2	727	519109	7802052
A2	728	519114	7802052
A2	729	519119	7802052
A2	730	519125	7802051
A2	731	519130	7802050
A2	732	519135	7802050
A2	733	519140	7802048
A2	734	519145	7802046
A2	735	519149	7802046
A2	736	519153	7802046
A2	737	519158	7802047
A2	738	519164	7802047
A2	739	519169	7802047
A2	740	519174	7802046
A2	741	519180	7802046
A2	742	519184	7802045
A2	743	519189	7802044
A2	744	519194	7802043
A2	745	519199	7802043
A2	746	519204	7802042
A2	747	519209	7802042
A2	748	519214	7802041
A2	749	519219	7802041
A2	750	519224	7802040
A2	751	519228	7802040
A2	752	519229	7802040
A2	753	519231	7802040
A2	754	519233	7802040
A2	755	519236	7802039
A2	756	519238	7802038
A2	757	519240	7802037
A2	758	519241	7802036
A2	759	519243	7802036
A2	760	519245	7802035
A2	761	519247	7802034
A2	762	519249	7802032
A2	763	519251	7802030
A2	764	519252	7802029
A2	765	519253	7802028
A2	766	519254	7802026
A2	767	519255	7802025
A2	768	519256	7802024
A2	769	519257	7802022
A2	770	519259	7802018
A2	771	519262	7802014
A2	772	519265	7802010
A2	773	519268	7802006
A2	774	519271	7802002
A2	775	519274	7801998
A2	776	519277	7801994
A2	777	519279	7801990
A2	778	519283	7801986
A2	779	519286	7801982
A2	780	519288	7801977

Part ID	Unique ID	Easting	Northing
A2	781	519291	7801973
A2	782	519294	7801969
A2	783	519297	7801965
A2	784	519299	7801962
A2	785	519300	7801961
A2	786	519303	7801957
A2	787	519306	7801953
A2	788	519309	7801949
A2	789	519312	7801945
A2	790	519315	7801940
A2	791	519317	7801936
A2	792	519320	7801932
A2	793	519323	7801928
A2	794	519326	7801924
A2	795	519329	7801920
A2	796	519332	7801916
A2	797	519334	7801912
A2	798	519337	7801907
A2	799	519340	7801903
A2	800	519343	7801899
A2	801	519346	7801895
A2	802	519349	7801891
A2	803	519352	7801887
A2	804	519355	7801883
A2	805	519357	7801879
A2	806	519360	7801875
A2	807	519363	7801871
A2	808	519366	7801867
A2	809	519369	7801863
A2	810	519372	7801859
A2	811	519375	7801855
A2	812	519378	7801851
A2	813	519381	7801846
A2	814	519384	7801842
A2	815	519387	7801838
A2	816	519390	7801834
A2	817	519392	7801830
A2	818	519395	7801826
A2	819	519398	7801822
A2	820	519400	7801817
A2	821	519403	7801814
A2	822	519406	7801810
A2	823	519410	7801805
A2	824	519411	7801803
A2	825	519411	7801803
A2	826	519412	7801802
A2	827	519412	7801801
A2	828	519413	7801800
A2	829	519414	7801799
A2	830	519414	7801799
A2	831	519415	7801799
A2	832	519417	7801797
A2	833	519418	7801796
A2	834	519419	7801795
A2	835	519420	7801794
A2	836	519423	7801791
A2	837	519428	7801789
A2	838	519431	7801785
A2	839	519435	7801783
A2	840	519439	7801781

Part ID	Unique ID	Easting	Northing
A2	841	519440	7801780
A2	842	519440	7801780
A2	843	519440	7801780
A2	844	519440	7801780
A2	845	519441	7801780
A2	846	519441	7801780
A2	847	519441	7801780
A2	848	519441	7801780
A2	849	519441	7801780
A2	850	519442	7801780
A2	851	519442	7801780
A2	852	519442	7801780
A2	853	519442	7801780
A2	854	519442	7801781
A2	855	519442	7801781
A2	856	519442	7801781
A2	857	519442	7801781
A2	858	519442	7801781
A2	859	519443	7801781
A2	860	519443	7801781
A2	861	519443	7801781
A2	862	519443	7801781
A2	863	519443	7801781
A2	864	519443	7801781
A2	865	519443	7801781
A2	866	519443	7801781
A2	867	519443	7801781
A2	868	519444	7801781
A2	869	519444	7801781
A2	870	519444	7801781
A2	871	519444	7801781
A2	872	519444	7801781
A2	873	519444	7801781
A2	874	519444	7801782
A2	875	519445	7801782
A2	876	519445	7801782
A2	877	519445	7801782
A2	878	519445	7801782
A2	879	519446	7801782
A2	880	519446	7801782
A2	881	519446	7801782
A2	882	519446	7801783
A2	883	519447	7801783
A2	884	519447	7801783
A2	885	519447	7801783
A2	886	519448	7801784
A2	887	519449	7801784
A2	888	519449	7801785
A2	889	519450	7801786
A2	890	519451	7801786
A2	891	519451	7801787
A2	892	519452	7801788
A2	893	519453	7801789
A2	894	519453	7801789
A2	895	519454	7801790
A2	896	519456	7801794
A2	897	519459	7801798
A2	898	519468	7801792
A2	899	519422	7801736
A2	900	519427	7801729

Attachment to Plan: 2201-26844 SDA
Derived Reference Points
Datum: GDA2020, Projection: MGA Zone 55

PLANS AND DOCUMENTS
referred to in the
DEVELOPMENT APPROVAL



SARA ref: 2201-26844 SDA

Date: 13 June 2022

Notes: Derived Reference Points are provided to assist in the location of area boundaries.
 Responsibility for locating these boundaries lies solely with the landholder and delegated contractor(s).
 Coordinates start at a point indicated on the accompanying plan and proceed in a clockwise direction.

Part ID	Unique ID	Easting	Northing
A2	901	519431	7801724
A2	902	519453	7801692
A2	903	519477	7801659
A2	904	519484	7801648
A2	905	520065	7800824
A2	906	520059	7800820
A2	907	520084	7800785
A2	908	520089	7800789
A2	909	520533	7800158
A2	910	520528	7800154
A2	911	520550	7800123
A2	912	520555	7800127
A2	913	521520	7798757
A2	914	521526	7798749
A2	915	515985	7802983
A2	916	515930	7803123
A2	917	515930	7803123
A2	918	515926	7803121
A2	919	515928	7803118
A2	920	515920	7803117
A2	921	515920	7803117
A2	922	515920	7803117
A2	923	515919	7803117
A2	924	515919	7803117
A2	925	515919	7803117
A2	926	515918	7803116
A2	927	515917	7803116
A2	928	515916	7803116
A2	929	515916	7803112
A2	930	515912	7803109
A2	931	515912	7803106
A2	932	515911	7803099
A2	933	515907	7803093
A2	934	515903	7803089
A2	935	515901	7803086
A2	936	515899	7803082
A2	937	515896	7803077
A2	938	515893	7803073
A2	939	515892	7803069
A2	940	515891	7803067
A2	941	515890	7803066
A2	942	515890	7803066
A2	943	515890	7803066
A2	944	515890	7803064
A2	945	515888	7803063
A2	946	515888	7803062
A2	947	515890	7803060
A2	948	515893	7803055
A2	949	515895	7803050
A2	950	515896	7803044
A2	951	515897	7803040
A2	952	515899	7803036
A2	953	515901	7803034
A2	954	515901	7803034
A2	955	515901	7803033
A2	956	515902	7803033
A2	957	515902	7803033
A2	958	515902	7803033
A2	959	515902	7803032
A2	960	515903	7803032

Part ID	Unique ID	Easting	Northing
A2	961	515903	7803032
A2	962	515904	7803032
A2	963	515909	7803029
A2	964	515913	7803026
A2	965	515916	7803022
A2	966	515920	7803019
A2	967	515924	7803016
A2	968	515928	7803014
A2	969	515932	7803011
A2	970	515936	7803008
A2	971	515940	7803005
A2	972	515945	7803001
A2	973	515948	7802997
A2	974	515951	7802995
A2	975	515956	7802993
A2	976	515960	7802990
A2	977	515965	7802987
A2	978	515969	7802984
A2	979	515969	7802984
A2	980	515969	7802984
A2	981	515969	7802984
A2	982	515969	7802983
A2	983	515970	7802983
A2	984	515970	7802983
A2	985	515970	7802983
A2	986	515970	7802983
A2	987	515971	7802983
A2	988	515971	7802983
A2	989	515973	7802983
A2	990	515978	7802983
A2	991	515985	7802983
A3	992	513900	7808402
A3	993	513879	7808424
A3	994	513864	7808439
A3	995	513864	7808440
A3	996	513750	7808559
A3	997	513762	7808564
A3	998	513720	7808603
A3	999	513587	7808729
A3	1000	513580	7808735
A3	1001	513571	7808745
A3	1002	513563	7808755
A3	1003	513554	7808764
A3	1004	513545	7808774
A3	1005	513536	7808784
A3	1006	513528	7808794
A3	1007	513519	7808804
A3	1008	513511	7808815
A3	1009	513503	7808825
A3	1010	513495	7808835
A3	1011	513487	7808846
A3	1012	513479	7808857
A3	1013	513471	7808867
A3	1014	513464	7808878
A3	1015	513456	7808889
A3	1016	513449	7808900
A3	1017	512695	7810024
A3	1018	512692	7810029
A3	1019	512703	7810036
A3	1020	512686	7810061

Part ID	Unique ID	Easting	Northing
A3	1021	512675	7810053
A3	1022	512631	7810120
A3	1023	512642	7810127
A3	1024	512619	7810161
A3	1025	512608	7810153
A3	1026	512503	7810310
A3	1027	512514	7810318
A3	1028	512458	7810401
A3	1029	512447	7810394
A3	1030	512336	7810560
A3	1031	512346	7810567
A3	1032	512302	7810635
A3	1033	512291	7810627
A3	1034	512117	7810887
A3	1035	512127	7810894
A3	1036	512097	7810940
A3	1037	512086	7810933
A3	1038	511712	7811490
A3	1039	511744	7811499
A3	1040	511751	7811504
A3	1041	512119	7810955
A3	1042	512113	7810951
A3	1043	512144	7810905
A3	1044	512150	7810909
A3	1045	512324	7810650
A3	1046	512318	7810646
A3	1047	512363	7810579
A3	1048	512369	7810583
A3	1049	512480	7810417
A3	1050	512474	7810413
A3	1051	512530	7810330
A3	1052	512535	7810334
A3	1053	512642	7810176
A3	1054	512636	7810172
A3	1055	512658	7810138
A3	1056	512664	7810142
A3	1057	512709	7810076
A3	1058	512703	7810072
A3	1059	512719	7810047
A3	1060	512725	7810051
A3	1061	512746	7810019
A3	1062	513482	7808922
A3	1063	513489	7808911
A3	1064	513496	7808901
A3	1065	513504	7808891
A3	1066	513511	7808880
A3	1067	513519	7808870
A3	1068	513527	7808860
A3	1069	513534	7808850
A3	1070	513542	7808840
A3	1071	513550	7808830
A3	1072	513558	7808820
A3	1073	513567	7808810
A3	1074	513575	7808801
A3	1075	513584	7808791
A3	1076	513592	7808781
A3	1077	513601	7808772
A3	1078	513610	7808763
A3	1079	513906	7808454
A3	1080	513900	7808402

Attachment to Plan: 2201-26844 SDA
Derived Reference Points
Datum: GDA2020, Projection: MGA Zone 55

PLANS AND DOCUMENTS
referred to in the
DEVELOPMENT APPROVAL



SARA ref: 2201-26844 SDA

Date: 13 June 2022

Notes: Derived Reference Points are provided to assist in the location of area boundaries.
Responsibility for locating these boundaries lies solely with the landholder and delegated contractor(s).
Coordinates start at a point indicated on the accompanying plan and proceed in a clockwise direction.

Part ID	Unique ID	Easting	Northing
A4	1081	508714	7817518
A4	1082	508751	7817533
A4	1083	508802	7817414
A4	1084	508837	7817334
A4	1085	508838	7817318
A4	1086	508831	7817317
A4	1087	508848	7817162
A4	1088	508855	7817163
A4	1089	508967	7816149
A4	1090	508960	7816149
A4	1091	508990	7815872
A4	1092	508997	7815872
A4	1093	509069	7815224
A4	1094	509070	7815211
A4	1095	509072	7815199
A4	1096	509074	7815186
A4	1097	509076	7815173
A4	1098	509078	7815161
A4	1099	509080	7815148
A4	1100	509082	7815136
A4	1101	509085	7815124
A4	1102	509087	7815111
A4	1103	509090	7815099
A4	1104	509093	7815086
A4	1105	509096	7815074
A4	1106	509097	7815069
A4	1107	509149	7815081
A4	1108	509158	7815042
A4	1109	509067	7815021
A4	1110	509060	7815052
A4	1111	509057	7815064
A4	1112	509054	7815077
A4	1113	509051	7815090
A4	1114	509048	7815103
A4	1115	509045	7815116
A4	1116	509043	7815128
A4	1117	509041	7815141
A4	1118	509038	7815154
A4	1119	509036	7815167
A4	1120	509034	7815180
A4	1121	509032	7815193
A4	1122	509031	7815206
A4	1123	509029	7815219
A4	1124	508958	7815868
A4	1125	508971	7815869
A4	1126	508940	7816146
A4	1127	508927	7816145
A4	1128	508816	7817159
A4	1129	508829	7817160
A4	1130	508812	7817315
A4	1131	508799	7817313
A4	1132	508797	7817323
A4	1133	508765	7817398
A4	1134	508714	7817518
A5	1135	509284	7815232
A5	1136	509288	7815234
A5	1137	509292	7815235
A5	1138	509297	7815237
A5	1139	509302	7815239
A5	1140	509306	7815241

Part ID	Unique ID	Easting	Northing
A5	1141	509311	7815243
A5	1142	509316	7815244
A5	1143	509320	7815246
A5	1144	509325	7815248
A5	1145	509330	7815250
A5	1146	509334	7815252
A5	1147	509339	7815253
A5	1148	509344	7815255
A5	1149	509348	7815257
A5	1150	509353	7815259
A5	1151	509358	7815261
A5	1152	509362	7815262
A5	1153	509367	7815264
A5	1154	509372	7815266
A5	1155	509376	7815268
A5	1156	509381	7815269
A5	1157	509386	7815271
A5	1158	509390	7815273
A5	1159	509395	7815275
A5	1160	509400	7815277
A5	1161	509404	7815278
A5	1162	509409	7815280
A5	1163	509414	7815282
A5	1164	509419	7815283
A5	1165	509423	7815285
A5	1166	509427	7815287
A5	1167	509432	7815289
A5	1168	509437	7815291
A5	1169	509442	7815292
A5	1170	509446	7815294
A5	1171	509452	7815296
A5	1172	509456	7815297
A5	1173	509461	7815299
A5	1174	509465	7815301
A5	1175	509470	7815303
A5	1176	509475	7815304
A5	1177	509479	7815306
A5	1178	509484	7815308
A5	1179	509489	7815310
A5	1180	509493	7815312
A5	1181	509498	7815313
A5	1182	509503	7815315
A5	1183	509507	7815317
A5	1184	509512	7815319
A5	1185	509517	7815321
A5	1186	509522	7815321
A5	1187	509526	7815324
A5	1188	509531	7815326
A5	1189	509536	7815327
A5	1190	509540	7815328
A5	1191	509545	7815331
A5	1192	509550	7815332
A5	1193	509554	7815334
A5	1194	509559	7815336
A5	1195	509564	7815337
A5	1196	509568	7815339
A5	1197	509573	7815341
A5	1198	509578	7815343
A5	1199	509582	7815345
A5	1200	509587	7815346

Part ID	Unique ID	Easting	Northing
A5	1201	509592	7815348
A5	1202	509596	7815350
A5	1203	509601	7815352
A5	1204	509606	7815354
A5	1205	509611	7815355
A5	1206	509616	7815357
A5	1207	509620	7815358
A5	1208	509625	7815360
A5	1209	509629	7815362
A5	1210	509634	7815363
A5	1211	509639	7815365
A5	1212	509643	7815367
A5	1213	509648	7815369
A5	1214	509653	7815371
A5	1215	509657	7815372
A5	1216	509662	7815374
A5	1217	509667	7815376
A5	1218	509672	7815377
A5	1219	509676	7815379
A5	1220	509681	7815381
A5	1221	509685	7815383
A5	1222	509690	7815385
A5	1223	509695	7815386
A5	1224	509700	7815388
A5	1225	509704	7815390
A5	1226	509709	7815392
A5	1227	509714	7815393
A5	1228	509718	7815395
A5	1229	509723	7815397
A5	1230	509728	7815398
A5	1231	509732	7815400
A5	1232	509736	7815402
A5	1233	509741	7815405
A5	1234	509746	7815406
A5	1235	509751	7815408
A5	1236	509756	7815410
A5	1237	509760	7815411
A5	1238	509764	7815413
A5	1239	509769	7815415
A5	1240	509774	7815417
A5	1241	509779	7815419
A5	1242	509783	7815421
A5	1243	509788	7815422
A5	1244	509793	7815424
A5	1245	509796	7815425
A5	1246	509487	7815281
A5	1247	509288	7815231
A5	1248	509284	7815232
A6	1249	511533	7815723
A6	1250	510683	7815578
A6	1251	509873	7815424
A6	1252	509857	7815439
A6	1253	509859	7815439
A6	1254	509864	7815440
A6	1255	509869	7815441
A6	1256	509873	7815442
A6	1257	509878	7815443
A6	1258	509883	7815444
A6	1259	509888	7815445
A6	1260	509893	7815446

Attachment to Plan: 2201-26844 SDA
Derived Reference Points
Datum: GDA2020, Projection: MGA Zone 55

PLANS AND DOCUMENTS
referred to in the
DEVELOPMENT APPROVAL



SARA ref: 2201-26844 SDA
Date: 13 June 2022

Notes: Derived Reference Points are provided to assist in the location of area boundaries.
Responsibility for locating these boundaries lies solely with the landholder and delegated contractor(s).
Coordinates start at a point indicated on the accompanying plan and proceed in a clockwise direction.

Part ID	Unique ID	Easting	Northing
A6	1261	509898	7815447
A6	1262	509903	7815448
A6	1263	509908	7815450
A6	1264	509913	7815450
A6	1265	509917	7815451
A6	1266	509922	7815452
A6	1267	509927	7815453
A6	1268	509932	7815454
A6	1269	509937	7815455
A6	1270	509943	7815456
A6	1271	509947	7815456
A6	1272	509952	7815457
A6	1273	509957	7815459
A6	1274	509962	7815459
A6	1275	509966	7815460
A6	1276	509972	7815461
A6	1277	509977	7815462
A6	1278	509982	7815463
A6	1279	509987	7815463
A6	1280	509992	7815464
A6	1281	509996	7815465
A6	1282	510001	7815466
A6	1283	510006	7815467
A6	1284	510011	7815468
A6	1285	510016	7815469
A6	1286	510021	7815470
A6	1287	510026	7815470
A6	1288	510031	7815471
A6	1289	510036	7815472
A6	1290	510041	7815473
A6	1291	510046	7815474
A6	1292	510050	7815475
A6	1293	510055	7815476
A6	1294	510060	7815477
A6	1295	510065	7815478
A6	1296	510070	7815479
A6	1297	510075	7815480
A6	1298	510080	7815481
A6	1299	510085	7815481
A6	1300	510090	7815482
A6	1301	510095	7815483
A6	1302	510100	7815484
A6	1303	510105	7815485
A6	1304	510109	7815486
A6	1305	510114	7815488
A6	1306	510120	7815488
A6	1307	510124	7815488
A6	1308	510129	7815490
A6	1309	510134	7815490
A6	1310	510139	7815492
A6	1311	510144	7815492
A6	1312	510149	7815493
A6	1313	510154	7815494
A6	1314	510159	7815494
A6	1315	510164	7815495
A6	1316	510169	7815496
A6	1317	510174	7815497
A6	1318	510179	7815497
A6	1319	510184	7815498
A6	1320	510189	7815499

Part ID	Unique ID	Easting	Northing
A6	1321	510193	7815500
A6	1322	510198	7815501
A6	1323	510203	7815502
A6	1324	510208	7815503
A6	1325	510213	7815503
A6	1326	510218	7815504
A6	1327	510223	7815505
A6	1328	510228	7815506
A6	1329	510233	7815507
A6	1330	510238	7815508
A6	1331	510242	7815509
A6	1332	510247	7815511
A6	1333	510252	7815512
A6	1334	510257	7815513
A6	1335	510262	7815513
A6	1336	510267	7815514
A6	1337	510272	7815515
A6	1338	510277	7815515
A6	1339	510282	7815516
A6	1340	510287	7815516
A6	1341	510292	7815517
A6	1342	510297	7815518
A6	1343	510302	7815519
A6	1344	510307	7815520
A6	1345	510311	7815521
A6	1346	510317	7815522
A6	1347	510321	7815522
A6	1348	510326	7815523
A6	1349	510331	7815525
A6	1350	510336	7815526
A6	1351	510341	7815527
A6	1352	510346	7815528
A6	1353	510351	7815528
A6	1354	510355	7815530
A6	1355	510360	7815531
A6	1356	510365	7815532
A6	1357	510370	7815533
A6	1358	510375	7815534
A6	1359	510380	7815535
A6	1360	510385	7815535
A6	1361	510390	7815536
A6	1362	510395	7815537
A6	1363	510400	7815538
A6	1364	510405	7815539
A6	1365	510409	7815540
A6	1366	510414	7815541
A6	1367	510419	7815543
A6	1368	510425	7815543
A6	1369	510430	7815544
A6	1370	510434	7815544
A6	1371	510439	7815546
A6	1372	510444	7815546
A6	1373	510449	7815547
A6	1374	510454	7815548
A6	1375	510459	7815549
A6	1376	510464	7815550
A6	1377	510469	7815551
A6	1378	510474	7815552
A6	1379	510478	7815553
A6	1380	510483	7815554

Part ID	Unique ID	Easting	Northing
A6	1381	510489	7815555
A6	1382	510493	7815555
A6	1383	510498	7815556
A6	1384	510503	7815557
A6	1385	510508	7815558
A6	1386	510513	7815558
A6	1387	510518	7815559
A6	1388	510523	7815560
A6	1389	510528	7815561
A6	1390	510533	7815562
A6	1391	510538	7815563
A6	1392	510543	7815564
A6	1393	510548	7815564
A6	1394	510553	7815565
A6	1395	510557	7815565
A6	1396	510562	7815566
A6	1397	510567	7815567
A6	1398	510572	7815568
A6	1399	510577	7815569
A6	1400	510582	7815570
A6	1401	510587	7815571
A6	1402	510592	7815572
A6	1403	510597	7815573
A6	1404	510602	7815574
A6	1405	510607	7815575
A6	1406	510612	7815575
A6	1407	510616	7815576
A6	1408	510621	7815577
A6	1409	510626	7815578
A6	1410	510631	7815579
A6	1411	510636	7815580
A6	1412	510641	7815581
A6	1413	510646	7815582
A6	1414	510651	7815583
A6	1415	510656	7815584
A6	1416	510661	7815585
A6	1417	510665	7815586
A6	1418	510671	7815587
A6	1419	510676	7815587
A6	1420	510680	7815588
A6	1421	510685	7815589
A6	1422	510690	7815590
A6	1423	510695	7815591
A6	1424	510700	7815592
A6	1425	510705	7815593
A6	1426	510709	7815594
A6	1427	510714	7815596
A6	1428	510720	7815597
A6	1429	510724	7815598
A6	1430	510730	7815598
A6	1431	510735	7815599
A6	1432	510740	7815599
A6	1433	510744	7815600
A6	1434	510749	7815601
A6	1435	510754	7815602
A6	1436	510759	7815603
A6	1437	510764	7815604
A6	1438	510769	7815605
A6	1439	510774	7815606
A6	1440	510779	7815607

Attachment to Plan: 2201-26844 SDA
Derived Reference Points
Datum: GDA2020, Projection: MGA Zone 55

PLANS AND DOCUMENTS
referred to in the
DEVELOPMENT APPROVAL



SARA ref: 2201-26844 SDA

Date: 13 June 2022

Notes: Derived Reference Points are provided to assist in the location of area boundaries.
Responsibility for locating these boundaries lies solely with the landholder and delegated contractor(s).
Coordinates start at a point indicated on the accompanying plan and proceed in a clockwise direction.

Part ID	Unique ID	Easting	Northing
A6	1441	510784	7815608
A6	1442	510789	7815608
A6	1443	510794	7815609
A6	1444	510799	7815610
A6	1445	510803	7815611
A6	1446	510808	7815612
A6	1447	510814	7815612
A6	1448	510818	7815613
A6	1449	510823	7815614
A6	1450	510828	7815615
A6	1451	510833	7815616
A6	1452	510838	7815617
A6	1453	510843	7815618
A6	1454	510848	7815618
A6	1455	510853	7815619
A6	1456	510858	7815620
A6	1457	510862	7815621
A6	1458	510867	7815622
A6	1459	510872	7815623
A6	1460	510877	7815624
A6	1461	510882	7815625
A6	1462	510887	7815626
A6	1463	510892	7815627
A6	1464	510897	7815628
A6	1465	510902	7815628
A6	1466	510907	7815629
A6	1467	510912	7815630
A6	1468	510917	7815631
A6	1469	510921	7815632
A6	1470	510927	7815633
A6	1471	510932	7815634
A6	1472	510937	7815634
A6	1473	510941	7815635
A6	1474	510946	7815636
A6	1475	510951	7815637
A6	1476	510956	7815638
A6	1477	510961	7815638
A6	1478	510966	7815639
A6	1479	510971	7815640
A6	1480	510976	7815641
A6	1481	510981	7815642
A6	1482	510985	7815643
A6	1483	510990	7815644
A6	1484	510995	7815645
A6	1485	511001	7815646
A6	1486	511005	7815646
A6	1487	511010	7815647
A6	1488	511015	7815648
A6	1489	511020	7815649
A6	1490	511025	7815650
A6	1491	511030	7815651
A6	1492	511035	7815651
A6	1493	511040	7815652
A6	1494	511045	7815653
A6	1495	511050	7815654
A6	1496	511054	7815655
A6	1497	511059	7815656
A6	1498	511064	7815657
A6	1499	511069	7815658
A6	1500	511074	7815659

Part ID	Unique ID	Easting	Northing
A6	1501	511079	7815659
A6	1502	511084	7815660
A6	1503	511089	7815661
A6	1504	511094	7815662
A6	1505	511099	7815663
A6	1506	511104	7815664
A6	1507	511109	7815665
A6	1508	511112	7815666
A6	1509	511091	7815773
A6	1510	511449	7815841
A6	1511	511468	7815742
A6	1512	511470	7815731
A6	1513	511470	7815731
A6	1514	511470	7815728
A6	1515	511470	7815727
A6	1516	511473	7815728
A6	1517	511478	7815729
A6	1518	511483	7815730
A6	1519	511488	7815731
A6	1520	511493	7815731
A6	1521	511498	7815732
A6	1522	511503	7815733
A6	1523	511505	7815734
A6	1524	511506	7815734
A6	1525	511507	7815734
A6	1526	511508	7815734
A6	1527	511509	7815735
A6	1528	511510	7815735
A6	1529	511511	7815736
A6	1530	511512	7815736
A6	1531	511513	7815736
A6	1532	511514	7815737
A6	1533	511515	7815738
A6	1534	511515	7815738
A6	1535	511516	7815739
A6	1536	511517	7815740
A6	1537	511518	7815740
A6	1538	511519	7815741
A6	1539	511519	7815742
A6	1540	511520	7815743
A6	1541	511521	7815743
A6	1542	511521	7815744
A6	1543	511522	7815745
A6	1544	511523	7815746
A6	1545	511523	7815747
A6	1546	511524	7815748
A6	1547	511524	7815749
A6	1548	511524	7815750
A6	1549	511525	7815751
A6	1550	511525	7815752
A6	1551	511525	7815753
A6	1552	511526	7815754
A6	1553	511526	7815755
A6	1554	511526	7815759
A6	1555	511527	7815763
A6	1556	511528	7815768
A6	1557	511529	7815773
A6	1558	511530	7815778
A6	1559	511531	7815783
A6	1560	511531	7815788

Part ID	Unique ID	Easting	Northing
A6	1561	511532	7815793
A6	1562	511533	7815795
A6	1563	511533	7815795
A6	1564	511533	7815797
A6	1565	511533	7815799
A6	1566	511534	7815801
A6	1567	511534	7815803
A6	1568	511535	7815804
A6	1569	511535	7815806
A6	1570	511536	7815808
A6	1571	511537	7815810
A6	1572	511537	7815812
A6	1573	511538	7815814
A6	1574	511539	7815816
A6	1575	511540	7815817
A6	1576	511541	7815819
A6	1577	511541	7815821
A6	1578	511542	7815823
A6	1579	511543	7815825
A6	1580	511544	7815826
A6	1581	511545	7815828
A6	1582	511547	7815830
A6	1583	511548	7815831
A6	1584	511549	7815833
A6	1585	511549	7815833
A6	1586	511550	7815834
A6	1587	511551	7815836
A6	1588	511552	7815837
A6	1589	511555	7815840
A6	1590	511558	7815844
A6	1591	511561	7815848
A6	1592	511564	7815852
A6	1593	511567	7815855
A6	1594	511571	7815859
A6	1595	511574	7815863
A6	1596	511577	7815867
A6	1597	511578	7815869
A6	1598	511579	7815871
A6	1599	511579	7815872
A6	1600	511580	7815873
A6	1601	511581	7815873
A6	1602	511581	7815874
A6	1603	511581	7815874
A6	1604	511581	7815874
A6	1605	511581	7815874
A6	1606	511581	7815874
A6	1607	511581	7815874
A6	1608	511581	7815875
A6	1609	511581	7815875
A6	1610	511582	7815878
A6	1611	511582	7815878
A6	1612	511582	7815878
A6	1613	511582	7815878
A6	1614	511582	7815878
A6	1615	511581	7815879
A6	1616	511580	7815880
A6	1617	511579	7815881
A6	1618	511579	7815882
A6	1619	511579	7815882
A6	1620	511578	7815882

**Attachment to Plan: 2201-26844 SDA
Derived Reference Points
Datum: GDA2020, Projection: MGA Zone 55**

**PLANS AND DOCUMENTS
referred to in the
DEVELOPMENT APPROVAL**



SARA ref: 2201-26844 SDA

Date: 13 June 2022

Notes: Derived Reference Points are provided to assist in the location of area boundaries.
Responsibility for locating these boundaries lies solely with the landholder and delegated contractor(s).
Coordinates start at a point indicated on the accompanying plan and proceed in a clockwise direction.

Part ID	Unique ID	Easting	Northing
A6	1621	511577	7815883
A6	1622	511576	7815884
A6	1623	511575	7815885
A6	1624	511575	7815886
A6	1625	511574	7815887
A6	1626	511573	7815887
A6	1627	511573	7815887
A6	1628	511573	7815888
A6	1629	511572	7815889
A6	1630	511572	7815889
A6	1631	511571	7815890
A6	1632	511570	7815890
A6	1633	511569	7815891
A6	1634	511568	7815892
A6	1635	511568	7815893
A6	1636	511567	7815893
A6	1637	511566	7815894
A6	1638	511566	7815895
A6	1639	511565	7815895
A6	1640	511565	7815895
A6	1641	511565	7815895
A6	1642	511564	7815896
A6	1643	511563	7815897
A6	1644	511562	7815898
A6	1645	511561	7815899
A6	1646	511560	7815899
A6	1647	511560	7815899
A6	1648	511564	7815903
A6	1649	511569	7815908
A6	1650	511642	7815845
A6	1651	511639	7815840
A6	1652	511638	7815841
A6	1653	511637	7815841
A6	1654	511636	7815842
A6	1655	511635	7815843
A6	1656	511635	7815843
A6	1657	511634	7815844
A6	1658	511633	7815844
A6	1659	511632	7815845
A6	1660	511631	7815845
A6	1661	511630	7815846
A6	1662	511630	7815847
A6	1663	511629	7815847
A6	1664	511628	7815848
A6	1665	511627	7815848
A6	1666	511626	7815849
A6	1667	511625	7815849
A6	1668	511625	7815850
A6	1669	511624	7815851
A6	1670	511623	7815851
A6	1671	511622	7815852
A6	1672	511621	7815852
A6	1673	511621	7815853
A6	1674	511620	7815853
A6	1675	511619	7815854
A6	1676	511618	7815855
A6	1677	511617	7815855
A6	1678	511616	7815856
A6	1679	511616	7815856
A6	1680	511615	7815857

Part ID	Unique ID	Easting	Northing
A6	1681	511614	7815857
A6	1682	511613	7815858
A6	1683	511613	7815858
A6	1684	511613	7815858
A6	1685	511613	7815858
A6	1686	511612	7815859
A6	1687	511612	7815859
A6	1688	511611	7815859
A6	1689	511611	7815859
A6	1690	511610	7815859
A6	1691	511610	7815859
A6	1692	511609	7815859
A6	1693	511609	7815860
A6	1694	511608	7815860
A6	1695	511608	7815860
A6	1696	511608	7815860
A6	1697	511607	7815859
A6	1698	511607	7815859
A6	1699	511606	7815858
A6	1700	511606	7815858
A6	1701	511605	7815858
A6	1702	511605	7815857
A6	1703	511604	7815857
A6	1704	511604	7815857
A6	1705	511604	7815856
A6	1706	511603	7815856
A6	1707	511603	7815856
A6	1708	511603	7815856
A6	1709	511603	7815855
A6	1710	511602	7815855
A6	1711	511601	7815854
A6	1712	511600	7815853
A6	1713	511600	7815853
A6	1714	511599	7815853
A6	1715	511599	7815852
A6	1716	511599	7815853
A6	1717	511597	7815850
A6	1718	511593	7815846
A6	1719	511590	7815843
A6	1720	511587	7815839
A6	1721	511583	7815835
A6	1722	511580	7815832
A6	1723	511577	7815828
A6	1724	511574	7815824
A6	1725	511571	7815821
A6	1726	511570	7815820
A6	1727	511569	7815819
A6	1728	511569	7815819
A6	1729	511569	7815818
A6	1730	511568	7815817
A6	1731	511567	7815816
A6	1732	511566	7815815
A6	1733	511565	7815813
A6	1734	511565	7815812
A6	1735	511564	7815811
A6	1736	511563	7815810
A6	1737	511562	7815808
A6	1738	511562	7815807
A6	1739	511561	7815806
A6	1740	511561	7815804

Part ID	Unique ID	Easting	Northing
A6	1741	511560	7815803
A6	1742	511560	7815802
A6	1743	511559	7815800
A6	1744	511559	7815799
A6	1745	511558	7815798
A6	1746	511558	7815796
A6	1747	511557	7815795
A6	1748	511557	7815793
A6	1749	511557	7815792
A6	1750	511556	7815791
A6	1751	511556	7815790
A6	1752	511556	7815789
A6	1753	511555	7815784
A6	1754	511554	7815779
A6	1755	511553	7815774
A6	1756	511553	7815769
A6	1757	511552	7815764
A6	1758	511551	7815759
A6	1759	511550	7815754
A6	1760	511549	7815751
A6	1761	511549	7815749
A6	1762	511548	7815747
A6	1763	511548	7815745
A6	1764	511547	7815743
A6	1765	511547	7815741
A6	1766	511546	7815740
A6	1767	511545	7815738
A6	1768	511544	7815736
A6	1769	511543	7815734
A6	1770	511542	7815732
A6	1771	511541	7815731
A6	1772	511539	7815729
A6	1773	511538	7815727
A6	1774	511537	7815726
A6	1775	511535	7815724
A6	1776	511534	7815723
A6	1777	511533	7815723
A7	1778	510783	7812949
A7	1779	510727	7812961
A7	1780	510021	7814014
A7	1781	509317	7815065
A7	1782	509309	7815075
A7	1783	509309	7815076
A7	1784	509266	7815066
A7	1785	509263	7815078
A7	1786	509286	7815111
A7	1787	509327	7815121
A7	1788	509343	7815098
A7	1789	509350	7815087
A7	1790	510064	7814022
A7	1791	510783	7812949
A8	1792	511141	7812415
A8	1793	511028	7812511
A8	1794	510928	7812660
A8	1795	510868	7812750
A8	1796	510812	7812834
A8	1797	510772	7812893
A8	1798	510809	7812886
A8	1799	510827	7812882
A8	1800	510901	7812773

**Attachment to Plan: 2201-26844 SDA
Derived Reference Points
Datum: GDA2020, Projection: MGA Zone 55**

**PLANS AND DOCUMENTS
referred to in the
DEVELOPMENT APPROVAL**



SARA ref: 2201-26844 SDA

Date: 13 June 2022

Notes: Derived Reference Points are provided to assist in the location of area boundaries.
Responsibility for locating these boundaries lies solely with the landholder and delegated contractor(s).
Coordinates start at a point indicated on the accompanying plan and proceed in a clockwise direction.

Part ID	Unique ID	Easting	Northing
A8	1801	511039	7812566
A8	1802	511141	7812415
A9	1803	511721	7811550
A9	1804	511684	7811533
A9	1805	511335	7812053
A9	1806	511169	7812301
A9	1807	511280	7812207
A9	1808	511446	7811960
A9	1809	511721	7811550
A10	1810	512210	7807551
A10	1811	512208	7807550
A10	1812	512203	7807548
A10	1813	512199	7807546
A10	1814	512194	7807545
A10	1815	512190	7807543
A10	1816	512185	7807541
A10	1817	512182	7807539
A10	1818	512182	7807539
A10	1819	512181	7807539
A10	1820	512181	7807538
A10	1821	512180	7807538
A10	1822	512179	7807538
A10	1823	512179	7807537
A10	1824	512179	7807537
A10	1825	512178	7807536
A10	1826	512178	7807535
A10	1827	512177	7807534
A10	1828	512177	7807534
A10	1829	512176	7807533
A10	1830	512176	7807532
A10	1831	512176	7807532
A10	1832	512175	7807531
A10	1833	512175	7807531
A10	1834	512175	7807530
A10	1835	512174	7807530
A10	1836	512174	7807529
A10	1837	512174	7807529
A10	1838	512174	7807528
A10	1839	512174	7807527
A10	1840	512174	7807527
A10	1841	512174	7807526
A10	1842	512174	7807526
A10	1843	512174	7807525
A10	1844	512173	7807522
A10	1845	512173	7807517
A10	1846	512173	7807512
A10	1847	512173	7807507
A10	1848	512173	7807502
A10	1849	512172	7807497
A10	1850	512172	7807493
A10	1851	512173	7807487
A10	1852	512173	7807482
A10	1853	512173	7807477
A10	1854	512173	7807471
A10	1855	512171	7807467
A10	1856	512171	7807462
A10	1857	512171	7807457
A10	1858	512170	7807452
A10	1859	512171	7807447
A10	1860	512171	7807442

Part ID	Unique ID	Easting	Northing
A10	1861	512170	7807437
A10	1862	512170	7807432
A10	1863	512170	7807427
A10	1864	512169	7807422
A10	1865	512169	7807418
A10	1866	512170	7807412
A10	1867	512169	7807406
A10	1868	512168	7807401
A10	1869	512168	7807400
A10	1870	512168	7807400
A10	1871	512168	7807399
A10	1872	512168	7807399
A10	1873	512168	7807399
A10	1874	512168	7807398
A10	1875	512168	7807398
A10	1876	512168	7807397
A10	1877	512168	7807397
A10	1878	512168	7807396
A10	1879	512168	7807396
A10	1880	512169	7807396
A10	1881	512169	7807395
A10	1882	512169	7807394
A10	1883	512170	7807394
A10	1884	512170	7807394
A10	1885	512170	7807393
A10	1886	512171	7807393
A10	1887	512172	7807392
A10	1888	512172	7807392
A10	1889	512172	7807391
A10	1890	512176	7807388
A10	1891	512180	7807384
A10	1892	512183	7807380
A10	1893	512187	7807376
A10	1894	512190	7807372
A10	1895	512192	7807370
A10	1896	512193	7807368
A10	1897	512196	7807364
A10	1898	512199	7807360
A10	1899	512202	7807357
A10	1900	512206	7807353
A10	1901	512210	7807350
A10	1902	512212	7807345
A10	1903	512216	7807342
A10	1904	512219	7807338
A10	1905	512222	7807333
A10	1906	512225	7807329
A10	1907	512228	7807326
A10	1908	512231	7807322
A10	1909	512235	7807319
A10	1910	512238	7807315
A10	1911	512242	7807312
A10	1912	512245	7807308
A10	1913	512249	7807304
A10	1914	512252	7807300
A10	1915	512254	7807296
A10	1916	512258	7807293
A10	1917	512261	7807289
A10	1918	512264	7807286
A10	1919	512270	7807282
A10	1920	512271	7807276

Part ID	Unique ID	Easting	Northing
A10	1921	512274	7807274
A10	1922	512278	7807270
A10	1923	512281	7807266
A10	1924	512284	7807263
A10	1925	512285	7807262
A10	1926	512287	7807260
A10	1927	512293	7807258
A10	1928	512296	7807253
A10	1929	512300	7807249
A10	1930	512303	7807245
A10	1931	512306	7807241
A10	1932	512309	7807237
A10	1933	512312	7807233
A10	1934	512315	7807230
A10	1935	512319	7807226
A10	1936	512322	7807222
A10	1937	512325	7807219
A10	1938	512329	7807215
A10	1939	512332	7807211
A10	1940	512335	7807208
A10	1941	512339	7807204
A10	1942	512342	7807200
A10	1943	512343	7807199
A10	1944	512345	7807197
A10	1945	512349	7807193
A10	1946	512352	7807189
A10	1947	512355	7807185
A10	1948	512359	7807182
A10	1949	512362	7807178
A10	1950	512366	7807174
A10	1951	512369	7807171
A10	1952	512373	7807167
A10	1953	512376	7807163
A10	1954	512379	7807160
A10	1955	512383	7807156
A10	1956	512386	7807152
A10	1957	512390	7807148
A10	1958	512393	7807145
A10	1959	512396	7807141
A10	1960	512399	7807137
A10	1961	512403	7807134
A10	1962	512406	7807130
A10	1963	512409	7807126
A10	1964	512413	7807122
A10	1965	512416	7807119
A10	1966	512419	7807115
A10	1967	512423	7807111
A10	1968	512426	7807108
A10	1969	512430	7807104
A10	1970	512433	7807100
A10	1971	512436	7807097
A10	1972	512440	7807092
A10	1973	512443	7807089
A10	1974	512446	7807085
A10	1975	512450	7807082
A10	1976	512453	7807078
A10	1977	512456	7807074
A10	1978	512460	7807070
A10	1979	512460	7807069
A10	1980	512462	7807067

**Attachment to Plan: 2201-26844 SDA
Derived Reference Points
Datum: GDA2020, Projection: MGA Zone 55**

**PLANS AND DOCUMENTS
referred to in the
DEVELOPMENT APPROVAL**



SARA ref: 2201-26844 SDA
Date: 13 June 2022

Notes: Derived Reference Points are provided to assist in the location of area boundaries.
Responsibility for locating these boundaries lies solely with the landholder and delegated contractor(s).
Coordinates start at a point indicated on the accompanying plan and proceed in a clockwise direction.

Part ID	Unique ID	Easting	Northing
A10	1981	512463	7807066
A10	1982	512466	7807063
A10	1983	512469	7807059
A10	1984	512473	7807056
A10	1985	512477	7807051
A10	1986	512477	7807051
A10	1987	512480	7807048
A10	1988	512483	7807045
A10	1989	512487	7807041
A10	1990	512490	7807037
A10	1991	512493	7807033
A10	1992	512496	7807029
A10	1993	512500	7807026
A10	1994	512503	7807022
A10	1995	512507	7807019
A10	1996	512510	7807015
A10	1997	512513	7807011
A10	1998	512517	7807008
A10	1999	512520	7807004
A10	2000	512524	7807000
A10	2001	512527	7806996
A10	2002	512530	7806992
A10	2003	512533	7806989
A10	2004	512536	7806985
A10	2005	512540	7806981
A10	2006	512543	7806977
A10	2007	512546	7806974
A10	2008	512550	7806970
A10	2009	512553	7806966
A10	2010	512556	7806962
A10	2011	512560	7806959
A10	2012	512563	7806955
A10	2013	512566	7806951
A10	2014	512570	7806947
A10	2015	512573	7806944
A10	2016	512576	7806940
A10	2017	512580	7806937
A10	2018	512583	7806933
A10	2019	512586	7806929
A10	2020	512590	7806926
A10	2021	512594	7806922
A10	2022	512594	7806921
A10	2023	512597	7806918
A10	2024	512600	7806915
A10	2025	512604	7806911
A10	2026	512607	7806907
A10	2027	512607	7806906
A10	2028	512610	7806903
A10	2029	512614	7806899
A10	2030	512617	7806895
A10	2031	512620	7806891
A10	2032	512623	7806887
A10	2033	512626	7806884
A10	2034	512629	7806880
A10	2035	512633	7806876
A10	2036	512636	7806873
A10	2037	512639	7806869
A10	2038	512643	7806865
A10	2039	512646	7806861
A10	2040	512649	7806858

Part ID	Unique ID	Easting	Northing
A10	2041	512653	7806854
A10	2042	512656	7806850
A10	2043	512659	7806847
A10	2044	512663	7806843
A10	2045	512666	7806839
A10	2046	512669	7806836
A10	2047	512673	7806832
A10	2048	512677	7806829
A10	2049	512680	7806825
A10	2050	512683	7806821
A10	2051	512687	7806817
A10	2052	512690	7806814
A10	2053	512693	7806810
A10	2054	512697	7806806
A10	2055	512700	7806802
A10	2056	512703	7806798
A10	2057	512706	7806795
A10	2058	512710	7806791
A10	2059	512713	7806787
A10	2060	512716	7806783
A10	2061	512720	7806780
A10	2062	512723	7806776
A10	2063	512726	7806772
A10	2064	512729	7806769
A10	2065	512729	7806769
A10	2066	512733	7806765
A10	2067	512736	7806761
A10	2068	512740	7806758
A10	2069	512743	7806753
A10	2070	512746	7806750
A10	2071	512749	7806746
A10	2072	512753	7806742
A10	2073	512756	7806739
A10	2074	512760	7806735
A10	2075	512763	7806731
A10	2076	512766	7806728
A10	2077	512770	7806724
A10	2078	512773	7806721
A10	2079	512777	7806717
A10	2080	512780	7806713
A10	2081	512784	7806710
A10	2082	512787	7806706
A10	2083	512791	7806702
A10	2084	512794	7806698
A10	2085	512797	7806695
A10	2086	512797	7806695
A10	2087	512800	7806691
A10	2088	512804	7806687
A10	2089	512807	7806683
A10	2090	512810	7806679
A10	2091	512813	7806675
A10	2092	512816	7806671
A10	2093	512819	7806668
A10	2094	512823	7806664
A10	2095	512826	7806660
A10	2096	512830	7806657
A10	2097	512833	7806653
A10	2098	512836	7806649
A10	2099	512840	7806645
A10	2100	512843	7806641

Part ID	Unique ID	Easting	Northing
A10	2101	512843	7806641
A10	2102	512844	7806640
A10	2103	512845	7806639
A10	2104	512845	7806639
A10	2105	512846	7806639
A10	2106	512847	7806638
A10	2107	512849	7806637
A10	2108	512850	7806635
A10	2109	512851	7806635
A10	2110	512851	7806634
A10	2111	512852	7806634
A10	2112	512854	7806633
A10	2113	512856	7806632
A10	2114	512857	7806630
A10	2115	512858	7806630
A10	2116	512858	7806630
A10	2117	512859	7806629
A10	2118	512861	7806628
A10	2119	512862	7806628
A10	2120	512863	7806627
A10	2121	512864	7806627
A10	2122	512866	7806626
A10	2123	512867	7806625
A10	2124	512868	7806625
A10	2125	512869	7806625
A10	2126	512870	7806624
A10	2127	512872	7806624
A10	2128	512873	7806624
A10	2129	512874	7806623
A10	2130	512875	7806623
A10	2131	512877	7806623
A10	2132	512878	7806623
A10	2133	512879	7806622
A10	2134	512879	7806622
A10	2135	512880	7806622
A10	2136	512882	7806622
A10	2137	512883	7806622
A10	2138	512884	7806622
A10	2139	512885	7806623
A10	2140	512887	7806623
A10	2141	512888	7806623
A10	2142	512889	7806623
A10	2143	512890	7806624
A10	2144	512891	7806624
A10	2145	512893	7806625
A10	2146	512895	7806625
A10	2147	512897	7806625
A10	2148	512898	7806625
A10	2149	512900	7806625
A10	2150	512900	7806626
A10	2151	512901	7806626
A10	2152	512901	7806626
A10	2153	512903	7806626
A10	2154	512904	7806627
A10	2155	512905	7806627
A10	2156	512906	7806628
A10	2157	512907	7806628
A10	2158	512908	7806629
A10	2159	512910	7806629
A10	2160	512911	7806630

**Attachment to Plan: 2201-26844 SDA
Derived Reference Points
Datum: GDA2020, Projection: MGA Zone 55**

**PLANS AND DOCUMENTS
referred to in the
DEVELOPMENT APPROVAL**



SARA ref: 2201-26844 SDA

Date: 13 June 2022

Notes: Derived Reference Points are provided to assist in the location of area boundaries.
Responsibility for locating these boundaries lies solely with the landholder and delegated contractor(s).
Coordinates start at a point indicated on the accompanying plan and proceed in a clockwise direction.

Part ID	Unique ID	Easting	Northing
A10	2161	512912	7806631
A10	2162	512913	7806632
A10	2163	512914	7806632
A10	2164	512915	7806633
A10	2165	512916	7806634
A10	2166	512918	7806635
A10	2167	512922	7806638
A10	2168	512926	7806641
A10	2169	512930	7806644
A10	2170	512934	7806646
A10	2171	512937	7806650
A10	2172	512942	7806654
A10	2173	512946	7806656
A10	2174	512949	7806652
A10	2175	512955	7806642
A10	2176	512923	7806620
A10	2177	512917	7806617
A10	2178	512911	7806614
A10	2179	512904	7806611
A10	2180	512897	7806609
A10	2181	512890	7806608
A10	2182	512883	7806608
A10	2183	512875	7806609
A10	2184	512868	7806610
A10	2185	512861	7806612
A10	2186	512855	7806614
A10	2187	512848	7806618
A10	2188	512842	7806622
A10	2189	512837	7806626
A10	2190	512832	7806631
A10	2191	512160	7807380
A10	2192	512157	7807384
A10	2193	512155	7807388
A10	2194	512154	7807392
A10	2195	512153	7807397
A10	2196	512137	7807397
A10	2197	512137	7807403
A10	2198	512137	7807408
A10	2199	512136	7807413
A10	2200	512136	7807419
A10	2201	512137	7807424
A10	2202	512138	7807429
A10	2203	512138	7807434
A10	2204	512138	7807439
A10	2205	512139	7807443
A10	2206	512139	7807448
A10	2207	512139	7807454
A10	2208	512140	7807459
A10	2209	512140	7807464
A10	2210	512141	7807468
A10	2211	512141	7807473
A10	2212	512141	7807478
A10	2213	512141	7807484
A10	2214	512142	7807489
A10	2215	512143	7807494
A10	2216	512143	7807498
A10	2217	512143	7807503
A10	2218	512143	7807508
A10	2219	512143	7807513
A10	2220	512143	7807518

Part ID	Unique ID	Easting	Northing
A10	2221	512143	7807523
A10	2222	512143	7807527
A10	2223	512143	7807527
A10	2224	512143	7807529
A10	2225	512144	7807531
A10	2226	512144	7807533
A10	2227	512144	7807535
A10	2228	512145	7807536
A10	2229	512145	7807538
A10	2230	512146	7807540
A10	2231	512147	7807542
A10	2232	512148	7807544
A10	2233	512149	7807546
A10	2234	512150	7807547
A10	2235	512151	7807548
A10	2236	512152	7807550
A10	2237	512153	7807551
A10	2238	512154	7807553
A10	2239	512155	7807554
A10	2240	512156	7807555
A10	2241	512157	7807556
A10	2242	512159	7807558
A10	2243	512159	7807558
A10	2244	512196	7807552
A10	2245	512210	7807551
A11	2246	513887	7808343
A11	2247	513885	7808323
A11	2248	513892	7808322
A11	2249	513888	7808283
A11	2250	513943	7808209
A11	2251	514033	7808089
A11	2252	514028	7808086
A11	2253	514054	7808052
A11	2254	514036	7808039
A11	2255	514011	7808073
A11	2256	514001	7808065
A11	2257	513846	7808271
A11	2258	513850	7808305
A11	2259	513852	7808327
A11	2260	513865	7808325
A11	2261	513869	7808361
A11	2262	513885	7808346
A11	2263	513887	7808343
A12	2264	514273	7807138
A12	2265	514274	7807126
A12	2266	514279	7807083
A12	2267	514180	7807158
A12	2268	514166	7807447
A12	2269	514159	7807588
A12	2270	514152	7807726
A12	2271	514145	7807873
A12	2272	514135	7807886
A12	2273	514131	7807890
A12	2274	514142	7807898
A12	2275	514110	7807941
A12	2276	514127	7807954
A12	2277	514156	7807915
A12	2278	514159	7807911
A12	2279	514163	7807914
A12	2280	514184	7807887

Part ID	Unique ID	Easting	Northing
A12	2281	514186	7807854
A12	2282	514203	7807505
A12	2283	514210	7807365
A12	2284	514219	7807179
A12	2285	514273	7807138
A13	2286	522389	7797161
A13	2287	522409	7797177
A13	2288	522387	7797221
A13	2289	522361	7797215
A13	2290	522213	7797504
A13	2291	522225	7797510
A13	2292	522131	7797693
A13	2293	522119	7797687
A13	2294	521978	7797963
A13	2295	521972	7797975
A13	2296	521966	7797986
A13	2297	521839	7798219
A13	2298	521833	7798230
A13	2299	521826	7798241
A13	2300	521820	7798253
A13	2301	521813	7798264
A13	2302	521807	7798275
A13	2303	521800	7798286
A13	2304	521793	7798296
A13	2305	521786	7798307
A13	2306	521779	7798318
A13	2307	521772	7798329
A13	2308	521765	7798339
A13	2309	521758	7798350
A13	2310	521602	7798571
A13	2311	521602	7798582
A13	2312	521581	7798670
A13	2313	521791	7798373
A13	2314	521798	7798362
A13	2315	521806	7798351
A13	2316	521813	7798340
A13	2317	521820	7798329
A13	2318	521827	7798318
A13	2319	521834	7798307
A13	2320	521841	7798295
A13	2321	521848	7798284
A13	2322	521855	7798273
A13	2323	521861	7798261
A13	2324	521868	7798250
A13	2325	521874	7798238
A13	2326	522001	7798005
A13	2327	522007	7797994
A13	2328	522013	7797982
A13	2329	522155	7797705
A13	2330	522149	7797702
A13	2331	522243	7797519
A13	2332	522249	7797522
A13	2333	522663	7796715
A13	2334	522695	7796651
A13	2335	522696	7796651
A13	2336	522691	7796661
A13	2337	522720	7796674
A13	2338	522731	7796678
A13	2339	522743	7796684
A13	2340	522749	7796686

**Attachment to Plan: 2201-26844 SDA
Derived Reference Points
Datum: GDA2020, Projection: MGA Zone 55**

PLANS AND DOCUMENTS referred to in the DEVELOPMENT APPROVAL

SARA ref: 2201-26844 SDA

Date: 13 June 2022

Notes: Derived Reference Points are provided to assist in the location of area boundaries. Responsibility for locating these boundaries lies solely with the landholder and delegated contractor(s). Coordinates start at a point indicated on the accompanying plan and proceed in a clockwise direction.

Part ID	Unique ID	Easting	Northing
A13	2341	522757	7796688
A13	2342	522761	7796692
A13	2343	522761	7796701
A13	2344	522750	7796728
A13	2345	522757	7796731
A13	2346	522794	7796645
A13	2347	522793	7796645
A13	2348	522790	7796644
A13	2349	522783	7796651
A13	2350	522779	7796657
A13	2351	522770	7796671
A13	2352	522758	7796667
A13	2353	522769	7796640
A13	2354	522769	7796640
A13	2355	522774	7796642
A13	2356	522836	7796499
A13	2357	522735	7796456
A13	2358	522672	7796598
A13	2359	522677	7796600
A13	2360	522627	7796697
A13	2361	522389	7797161

Part ID	Unique ID	Easting	Northing

Part ID	Unique ID	Easting	Northing