



DREAMS ARE BUILT

Building Services Pty Ltd

# Appendix 2

---

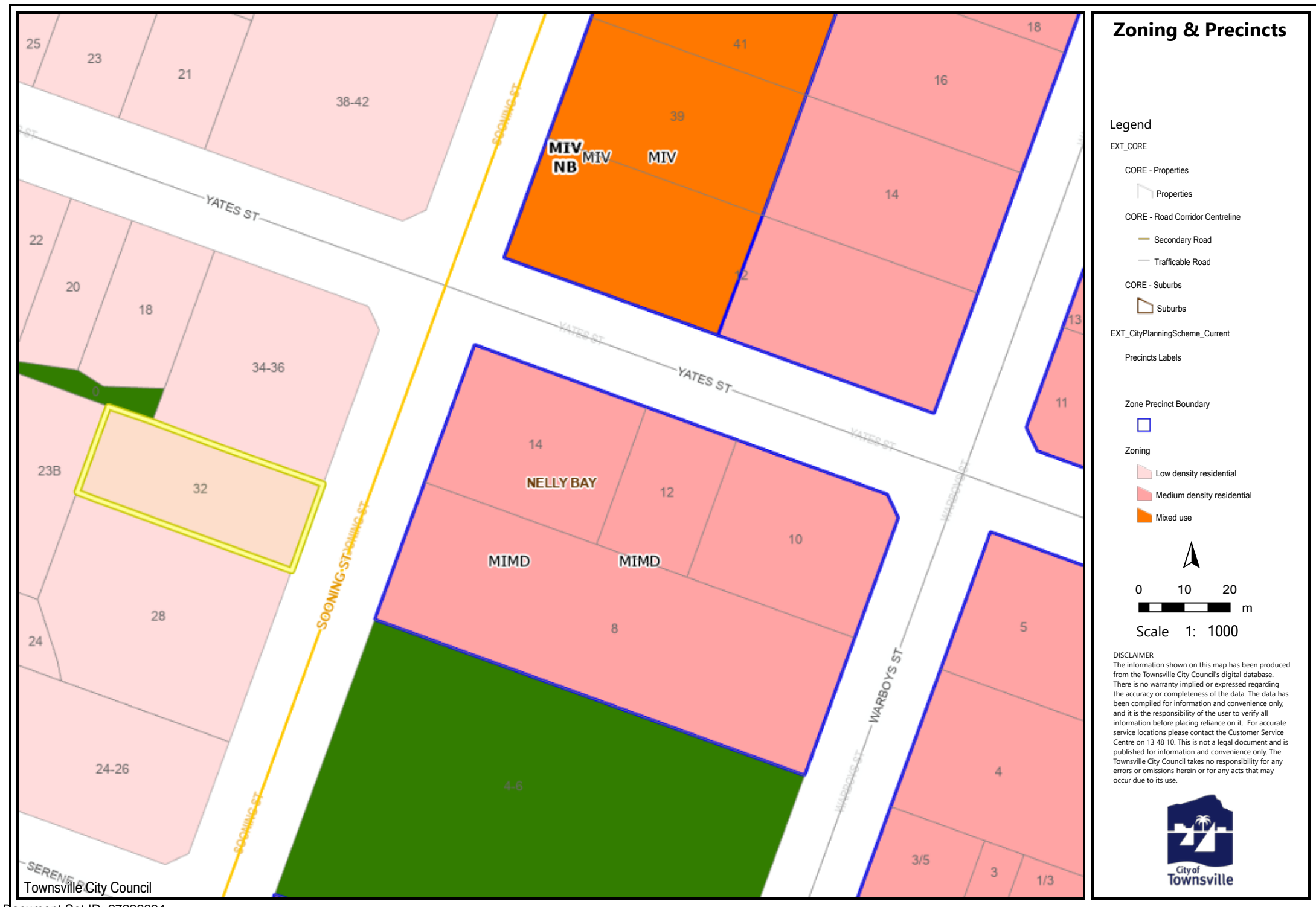

**Zoning & Precincts**

**Legend**

- EXT\_CORE
- CORE - Properties
- Properties
- CORE - Road Corridor Centreline
- Secondary Road
- Trafficable Road
- CORE - Suburbs
- Suburbs
- EXT\_CityPlanningScheme\_Current
- Precincts Labels
- Zone Precinct Boundary
- Zoning
  - Low density residential
  - Medium density residential
  - Mixed use

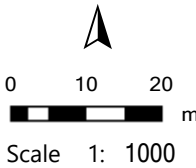

**DISCLAIMER**  
The information shown on this map has been produced from the Townsville City Council's digital database. There is no warranty implied or expressed regarding the accuracy or completeness of the data. The data has been compiled for information and convenience only, and it is the responsibility of the user to verify all information before placing reliance on it. For accurate service locations please contact the Customer Service Centre on 13 48 10. This is not a legal document and is published for information and convenience only. The Townsville City Council takes no responsibility for any errors or omissions herein or for any acts that may occur due to its use.



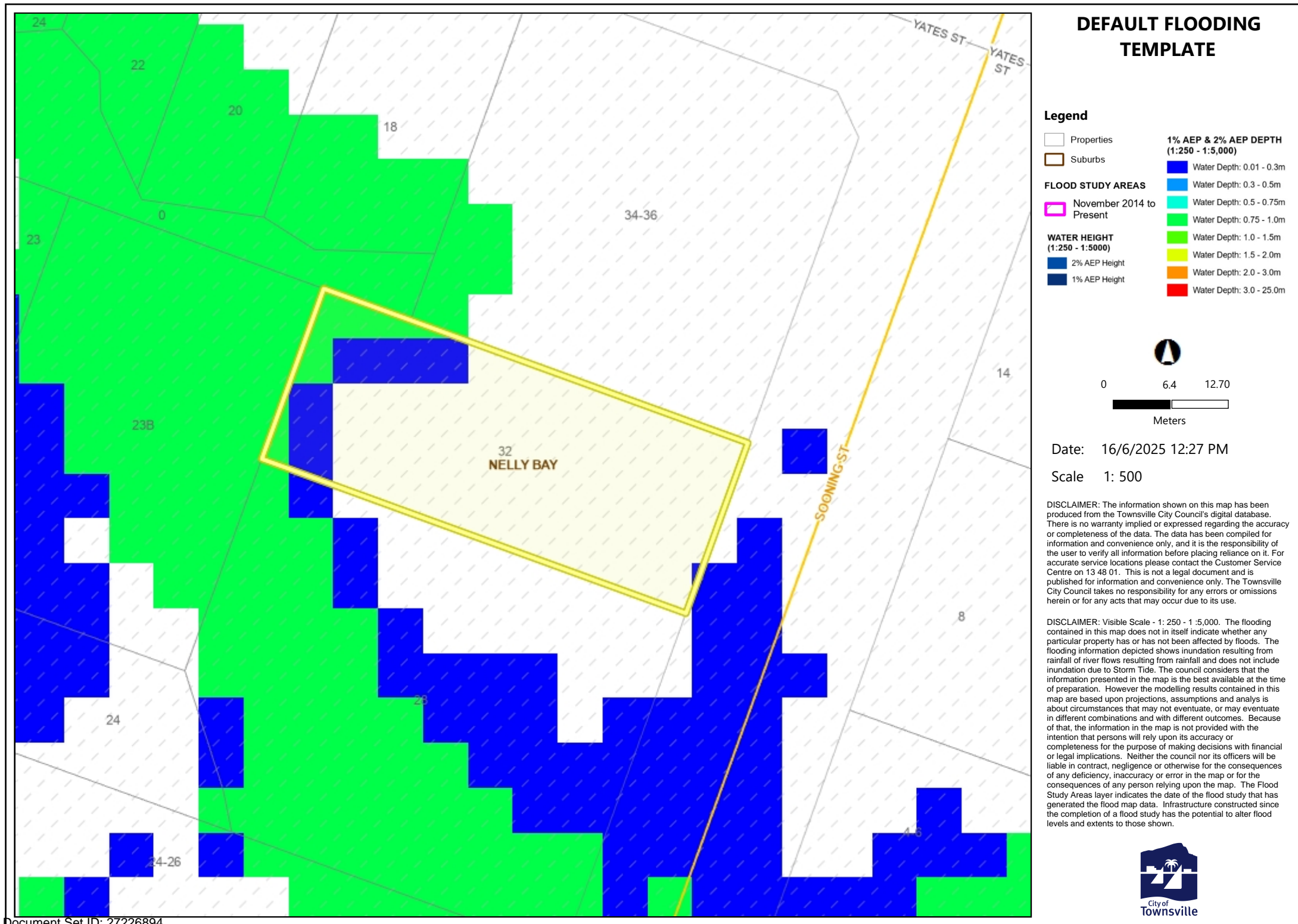

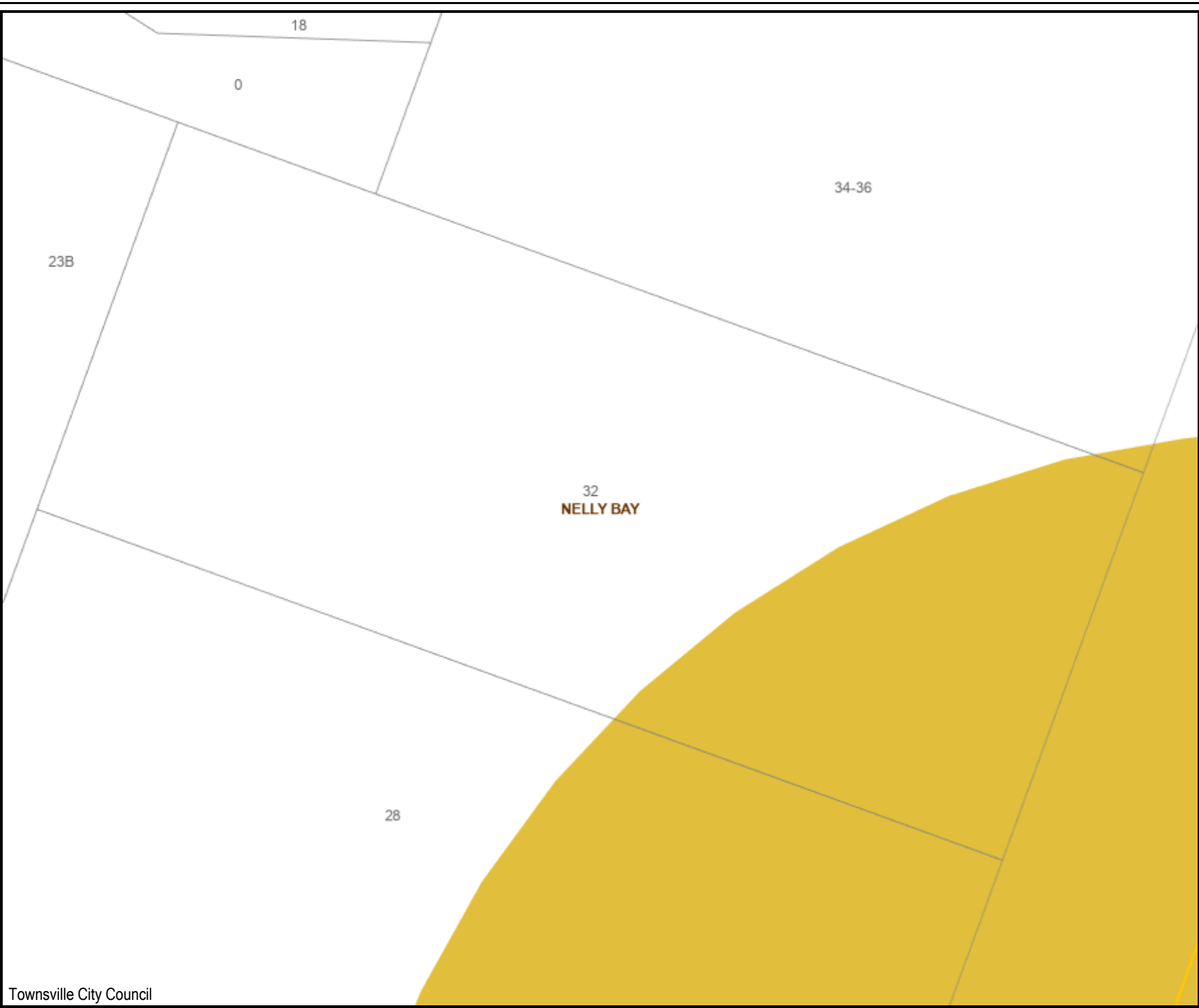

Bushfire Mapping

Legend

EXT\_CORE

CORE - Properties



CORE - Road Corridor Centreline



CORE - Suburbs



EXT\_CityPlanningScheme\_Current

Bushfire hazard area (OM-02.0)

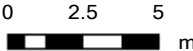

Scale 1: 250

DISCLAIMER  
The information shown on this map has been produced from the Townsville City Council's digital database. There is no warranty implied or expressed regarding the accuracy or completeness of the data. The data has been compiled for information and convenience only, and it is the responsibility of the user to verify all information before placing reliance on it. For accurate service locations please contact the Customer Service Centre on 13 48 10. This is not a legal document and is published for information and convenience only. The Townsville City Council takes no responsibility for any errors or omissions herein or for any acts that may occur due to its use.



# Infrastructure

Legend



0 2.5 5  
m

Scale 1: 250

**DISCLAIMER**  
The information shown on this map has been produced from the Townsville City Council's digital database. There is no warranty implied or expressed regarding the accuracy or completeness of the data. The data has been compiled for information and convenience only, and it is the responsibility of the user to verify all information before placing reliance on it. For accurate service locations please contact the Customer Service Centre on 13 48 10. This is not a legal document and is published for information and convenience only. The Townsville City Council takes no responsibility for any errors or omissions herein or for any acts that may occur due to its use.

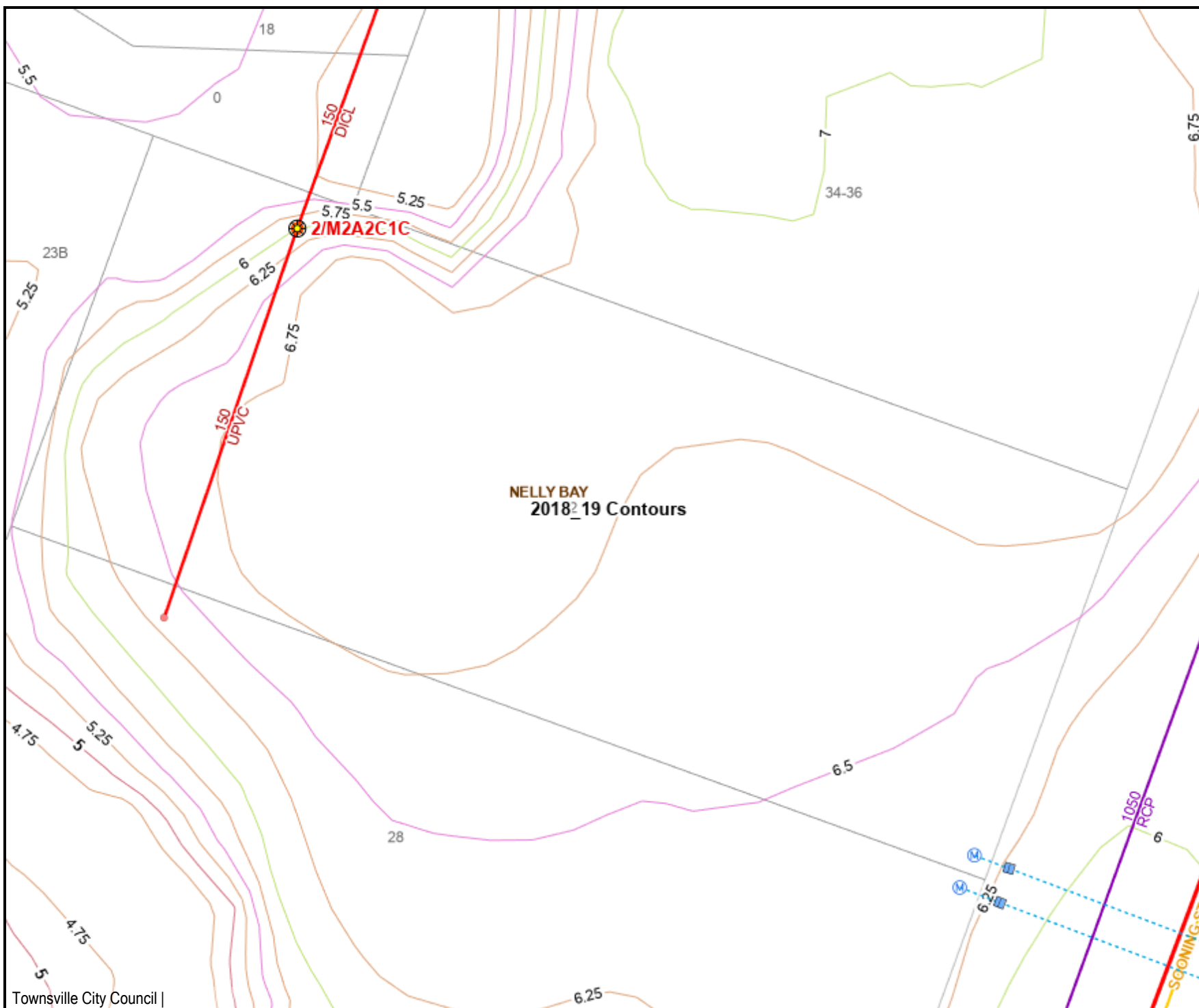

# Townsville City Council

## Asset Infrastructure : Full Reference / Legend

### Storm Water Asset

#### End Structure

- End Wall
- End Wall with Flap
- End Wall with Tide Flex Valve
- Outlet
- Pipe End

#### Man Hole

- Drainage Manhole
- Drainage Manhole with Flap

#### Network Structure

- Energy Dissipator
- Pump Station
- Tide Gate
- Weir Wall

#### Pit

- Combo
- Field Inlet
- Gully Pit
- Gully Trap
- High Point
- Incomplete Data S/W
- Inspection Opening
- Side Inlet Pit
- Special Inlet
- Stormwater Junction

#### Pollution Trap

- Gross Pollution Trap
- Inline Pollution Trap
- Screening Chamber

#### Detention Basin

- Detention Basin

#### Schematic

- Schematic

#### Stormwater Pipe Box

- Stormwater Pipe Box

#### Stormwater Pipe Circular

- Rising Main
- Stormwater Pipe
- Stormwater Pipe - Asbestos Cement
- Stormwater Pipe Unknown

#### Stormwater Sub Soil

- Seepage Drain
- Seepage Drain - Asbestos Cement
- Subsoil Connection Pipe

#### Surface Drainage

- Natural Waterway
- Open Drain
- Open Drain - Asbestos Cement
- Overland Flowpath
- Scour Protection

### Water Asset

#### Access Chamber

- Access Pit
- Flow Chamber
- Oriface Plate

#### Cathodic Protection Point

- Cathodic Protection Point
- Earth

#### Control Valve

- Air
- Air Cock
- Control
- Flush
- Manual Air Bleed
- Reflux
- Scour

#### Fitting

- Bend
- Blank Flange
- Chlorine Injector
- Dosing Point
- Drinking Fountain
- Elbow
- End Cap
- Gibault Joint
- Hose Cock
- Incomplete Fitting
- Insertion Point
- Junction Pit
- Overflow Outlet
- Plugged Riser
- Recovery Point
- Reducer
- Scour Outlet
- Sleeve
- T-Junction
- Tapping Band
- Thrust Flange
- Vent
- Water Dot
- Water Outlet
- X-Junction

#### Hydrant

- Hydrant

#### Meter

- Flow Meter
- Meter

#### Network Structure

- Booster Pump
- Chlorinator
- Reservoir
- Tank
- Treatment Plant
- Water Tower
- Weir

#### Sampling Station

- Sampling Station

#### Sensor

- Sensor

#### Stand Pipe

- Stand Pipe

#### System Valve

- Altitude
- Butterfly
- Bypass
- Critical Closed Valve
- Critical Open Valve
- Ferrule Cock
- Flange
- Gate
- Isolation
- Penstock
- Riser With Valve
- S-Valve
- Sec
- Shut Off
- Valve Pit

#### Regulator

- Pressure Reducing

#### Cathodic Protection Line

- Cathodic Protection Line

#### Water Main

- Distribution Main
- Distribution Main - Asbestos Cement
- Raw Water Main
- Reticulation Main
- Reticulation Main - Asbestos Cement
- Trunk Main
- Trunk Main - Asbestos Cement

#### Water Service

- Water Service
- Water Service - Asbestos Cement

### Waste Water Asset

#### Control Valve

- Air Valve
- G Valve
- R Valve

#### Fitting

- Anchor Block
- Bend
- Dot
- End Cap
- Incomplete Fitting
- Inspection Bend
- Inspection Opening
- Inspection Pipe
- Manhole Vent
- Press T Junction
- Press X Junction
- PTC Sleeve
- Reducer
- Sleeve
- T Junction
- Tit
- Tyton Lok
- Vent Header
- Vent Junction

#### Maintenance Hole

- Maintenance Shaft
- Sewer Manhole

#### Meter

- Meter
- Reuse Meter

#### Network Structure

- Booster Pump
- Holding Tank
- Overflow Tank
- Pump Station

- Treatment Plant

#### Overflow Pit

- Absorption Trench
- Manual Air Bleed
- Overflow Outlet
- Scour Outlet

### Fibre Optics Asset

#### Fibre Optics Nodes

- Comms\_Rack
- Frame
- Service\_Pit
- Termination\_Point

#### Fibre Optics Lines

- Copper
- Fibre-Optic

#### Pit

- Air Injection Point
- Blank Flange
- Hatch Box
- Inspection Chamber
- Scour Pit

#### Property Connection Point

- Boundary Point
- House Connection
- House Connection Double
- Inspection Junction
- Jump Up
- Oblique Branch
- Oblique Branch Inspection Opening

#### Stand Pipe

- Stand Pipe

#### Valve

- S Valve
- Scour

#### Gravity Main

- Effluent
- Effluent - Asbestos Cement
- Non Pressure Treated Main
- Overflow
- Overflow - Asbestos Cement
- Reticulation
- Reticulation - Asbestos Cement
- Trunk
- Trunk - Asbestos Cement

#### Pressure Main

- Reuse Main
- Rising Main
- Rising Main - Asbestos Cement
- Scour Main
- Scour Main - Asbestos Cement

#### Service

- Property Connection
- Property Connection - Asbestos Cement

